

MIDITEC
SECURITY SYSTEMS

Integrated solutions for space and time.
Technology meets design.



Product Catalogue **Hotel Solution**

Access Control | Room Management | Facility Security
valid from 10/2016

Table of contents

MIDITEC	3
Consulting.....	4
HOTEL SOLUTION	
MTZ® Hotel Solution	7
milock Room Information System	9
Interfaces	
Interface to Ariane	10
Elevator Interface Kone	11
HARDWARE	
On- and/or Offline	13
HOTELROOMS	
Access Reader for Hotel Rooms	
Reader	15
Reader with Parameterisable Display	19
Reader with DND/MUR Status Indication	22
DND/MUR Status Indication	23
Door Terminals for Hotel Rooms	
milock Wireless Lock	25
milock Focus	27
Door handle types	29
Room Control for Hotel Rooms	
Bedside Panel	32
Temperature Control	36
Intelligent Hotel Card Switch	38
DND/MUR Switch	40
Energy-Saving Terminal	42
Door Gong	43
HOTEL	
Access Control Unit	45
Access Reader	46
PegaSys Door Terminals	57
ACCESSORIES	
Door Controller	63
Light Extension	65
Climate Extension	66
Key Coder	67
IDs Key Rings	68
Power Supply Unit	69

Door Terminals PegaSys	70
Profile Half Cylinder Body	71
Design Examples Hotel BJE	73
Siedle Reader Colour Options	75
HOSPITALITY	
Configuration Examples	76
Time Management	82
SERVICE	
Training	84
REFERENCES	
Hotels	86

© 2017 MIDITEC Datensysteme GmbH

All rights reserved. No part of this document may be reproduced or transmitted in any form without written permission from MIDITEC. The information in this document is subject to change without prior notification.

This product catalogue has been compiled with the greatest care and attention. However, MIDITEC does not guarantee that the product catalogue is complete and correct. Subject to errors and alterations. All rights reserved by MIDITEC Datensysteme GmbH.

Company

MIDITEC Datensysteme GmbH

MIDITEC

The name MIDITEC has stood for innovative products in the fields of access management, building security and time management for more than 30 years. As one of the leading suppliers in this industry, we develop and produce our components exclusively in Germany, but also deliver them far beyond the German borders. We have prestigious reference buildings in many European countries and the Arab world. Since 2003, MIDITEC has been represented by its own sales offices in the United Arab Emirates.

HARDWARE AND SOFTWARE FROM ONE SOURCE

The most important success factors of our products are quality and modularity. All hardware and software components are optimally compatible and can be combined with practically any configuration. This results in highly integrated solutions tailored ideally to the individual needs and wishes of each customer.

DESIGN AS A HOLISTIC PROCESS

Product development is about more than pure technology. Economic aspects and aesthetics must be given just as much attention. What we mean is: Security installations must never be perceived as disturbing. They should blend harmoniously into their respective environment. Design is therefore a holistic process at MIDITEC, which allows for individual designs to suit personal needs and wishes, from industrial functionality to tasteful exclusivity.

Whether access, security or time management, whether on-line or offline: MIDITEC offers precise fitting solutions from one source – competitively, efficiently and dependably.



You can find the General Terms and Conditions here:
www.miditec.de/agb



Consulting

Customized Solutions from MIDITEC

Company Consulting

CUSTOMIZED SOLUTIONS FROM MIDITEC

Our consulting begins with the first conversation. Our experienced marketing consultants listen to your assignment of tasks and the related aims and requirements. On this basis, together with our technical team, we develop an optimal solution and present it to you with all the appropriate modules.

And because almost every task is individual, we at MIDITEC have developed a modular system that, in the end, is always a bit different than many other solutions. This approach enables us to develop customized solutions with already existing modules, which are however continuously further developed.

CUSTOMER PROXIMITY FROM A TO Z

The implementation of individual customer demands is a recurrent theme, from the project planning to the after-sales support. It starts with the qualified consulting after a thorough analysis of the requirements. The professional project management follows, a part of which is the commissioning of the hardware and the installation of the software. Employee training, with consideration of their individual requirements ensure the optimal use of the systems, supported by practical documentation and the customer-oriented Hotline-Service. Apart from the headquarters in Bremen, there are nationwide distributors to take care of the geographical proximity to the customers.

We look forward to your appointment!
Phone: 0421 17581-0
eMail: info@miditec.de





MTZ® Hotel Solution

Access Management | Room Management | Facility Security

Software

MTZ® Hotel Solution

The hotel guest of today is sophisticated. He wants security, comfort and aesthetics. Thus, the technical facilities in hotels have to meet particularly high demands: They have to be reliable, easy to service and user-friendly, facilitate the employees work, but at the same time offer the guest a concrete advantage and visually adapt to the environment.

MIDITEC develops holistic solutions for the technical hotel management, from access control to room control and building security. Innovative technology, highly customisable, ergonomically optimized and aesthetically sophisticated. Thanks to the modular structure and versatile interfaces, they can be put together based on your own individual needs, easily integrated into existing infrastructures and can be expanded when required.

Therefore MIDITEC solutions are always an investment in the future. They grow with the requirements, adjust to the circumstances and meet not only the demands of today, but also of tomorrow.

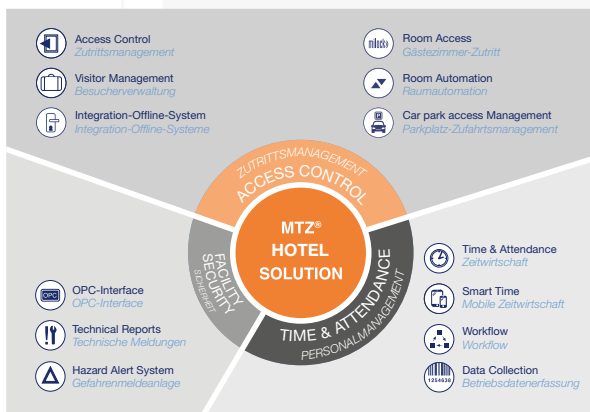

MTZ® HOTEL SOLUTION

Software for online locking systems in hotels; system management and card coding for personnel and guests; integration of offline hotel readers as well as hotel readers and locks; web-based technology with application server. The integration of other MTZ® Business Solution modules is supported.

FUNCTIONS

- Creation of a key masterplan on the basis of areas and individual doors
- Personnel access
- Area access for personnel and guests

Fig. "Check In" dialog box

LOCKING AUTHORISATIONS

- Comprehensive time programmes in the locks control the access
- Optional permanent door release for wall readers
- Up to 16 weekly programmes for each door
- Up to 4 time zones can be programmed for each day
- Management of holidays and blocked days
- Integrated clock with automatic daylight saving time function
- Continuous calendar management up to 2099
- Suite function: 4 doors can be allocated to one room
- Up to 4 individual doors can be allocated to each employee
- Cards become automatically invalid on check-out and/or expiration
- Individual authorisations for time-related access authorisation
- Conversion / expansion to online system possible

REPLACEMENT CARDS

- Simple issue of replacement cards
- Lost guest cards become invalid automatically when new cards are created
- Blocked lists for lost cards

SECURITY

- Access via password and user name
- User authorisations up to dialog box level: Read, change, delete, print, and create
- Each system has its own system code

Software

MTZ® Hotel Solution

▼ BASIC MODULE MTZ® HOTEL SOLUTION

MB5401	MTZ® Hotel Solution up to 32 doors incl. 50 employees
MB5402	MTZ® Hotel Solution up to 64 doors incl. 50 employees
MB5403	MTZ® Hotel Solution up to 128 doors incl. 50 employees
MB5404	MTZ® Hotel Solution up to 256 doors incl. 50 employees
MB5405	MTZ® Hotel Solution up to 512 doors incl. 100 employees
MB5406	MTZ® Hotel Solution up to 1,024 doors incl. 100 employees

Larger number of rooms on request.

▼ EXTENSION MODULE DOORS

MB5407	Extension MTZ® Hotel Solution by 32 doors
MB5408	Extension MTZ® Hotel Solution by 64 doors
MB5409	Extension MTZ® Hotel Solution by 128 doors

▼ INTERFACES

MB5460	Fidelio
MB5461	Protel
MB5463	Casablanca
MB5464	Gastro Profi
MB5465	HMS-Info
MB5466	Citadel
MB5467	HOSTPMS
MB5472	Interface to Ariane
MB5385	Elevator Interface Kone

Other interfaces for front office systems on request.

Note: Possibly resulting expenses on front office side as licensing or service charges are not included. You may have to contact the respective manufacturers.

▼ EXTENSION MODULE EMPLOYEES

MB5413	Extension MTZ® Hotel Solution by 50 employees
MB5414	Extension MTZ® Hotel Solution by 100 employees

▼ EXTENSION MODULE

MB5471	milock Room Information System
MB5386	Climate Management
MB5410	Online usage up to 32 doors
MB5411	Online usage from 129 doors
MB5412	PegaSys Licence per fitting / cylinder

Software

milock Room Information System Extension for MTZ® Hotel Solution

MILOCK ROOM INFORMATION SYSTEM

The room status information system answers questions like: „Is it allowed to disturb guest in room 318?“ (DND) or „Which guests want their room cleaned?“ (MUR). An unlimited number of information systems for different target groups (e.g., technicians, cleaners, front office, ...) can be defined. Various reports can be generated and printed.

Only in combination with MTZ® Hotel Solution, incl. online use.

Zimmernummer:	1001	1002	1003	1004	1005	1006	1007	1008	1009	1010	1011	1012
Zimmer belegt												
Tür nicht geschlossen												
DND												
MUR												
Energiefreigabe aktiv												
Minibar prüfen												
Cleaned up												

Fig. Rooms of one floor - all states

Zimmernummer:	1001	1002	1003	1004	1005	1006	1007	1008	1009	1010	1011	1012
MUR												
DND												
MUR/DND												
MUR												
DND												
MUR/DND												
MUR												
DND												
MUR/DND												
MUR												
DND												
MUR/DND												

Fig. MUR/DND overview

DISPLAY OF

- Room status
- Energy circuit active per room
- MUR/DND active
- Cleaned up
- Check minibar
- Door not closed
- Time of last status change

DISPLAY

- Individual room display
- Freely definable display areas
- Scaleable display
- Real-time display
- Flashing status display optional
- Free selection of status indication colours
- Free selection of status indication acronyms

FUNCTIONS

- Current data and status retrieval
- Service information
- Report generation

▼ MILOCK ROOM INFORMATION SYSTEM

MB5471

milock Room Information System

Software Interfaces

INTERFACE TO ARIANE

The interface to Ariane enables communication between multiple hotel check-in solutions developed by Ariane Systems and the MTZ® HS.

Ariane hotel solutions can write and issue ID cards. The data required for the ID cards are requested from the MTZ® HS via the Ariane interface. Additionally, Ariane solutions transfer so-called key options to the MTZ. The key options contain information on additional door authorisations, such as front doors, corridor doors, sauna, etc.

Ariane hotel solutions receive all reservation data from the corresponding PMS (property management system).

▼ ORDER NUMBER

MB5472

Interface to Ariane

When ordering the interface to Ariane it is necessary to specify the required key options.

Software Interfaces

MTZ® ACCESS ELEVATOR INTERFACE KONE



The MTZ® Access Elevator Interface Kone allows a smooth data exchange between the MTZ® BS and an existing Kone elevator system.

With the MTZ® Access Elevator Interface Kone multiple Kone installations (Kone controllers) can be used with only one MTZ® installation. Thus, it is possible to control 2 separate Kone elevator installations of different skyscraping towers with one central MTZ® HS.

▼ ORDER NUMBER

MB5385

MTZ® Access Elevator Interface Kone,
Version 6.8, ELiv1.8, Hybrid DCS Basic

When ordering the MTZ® Access Elevator Interface Kone the number of group controllers must be specified.

MTZ® Access Elevator Interface Kone is certified by the KONE GmbH.

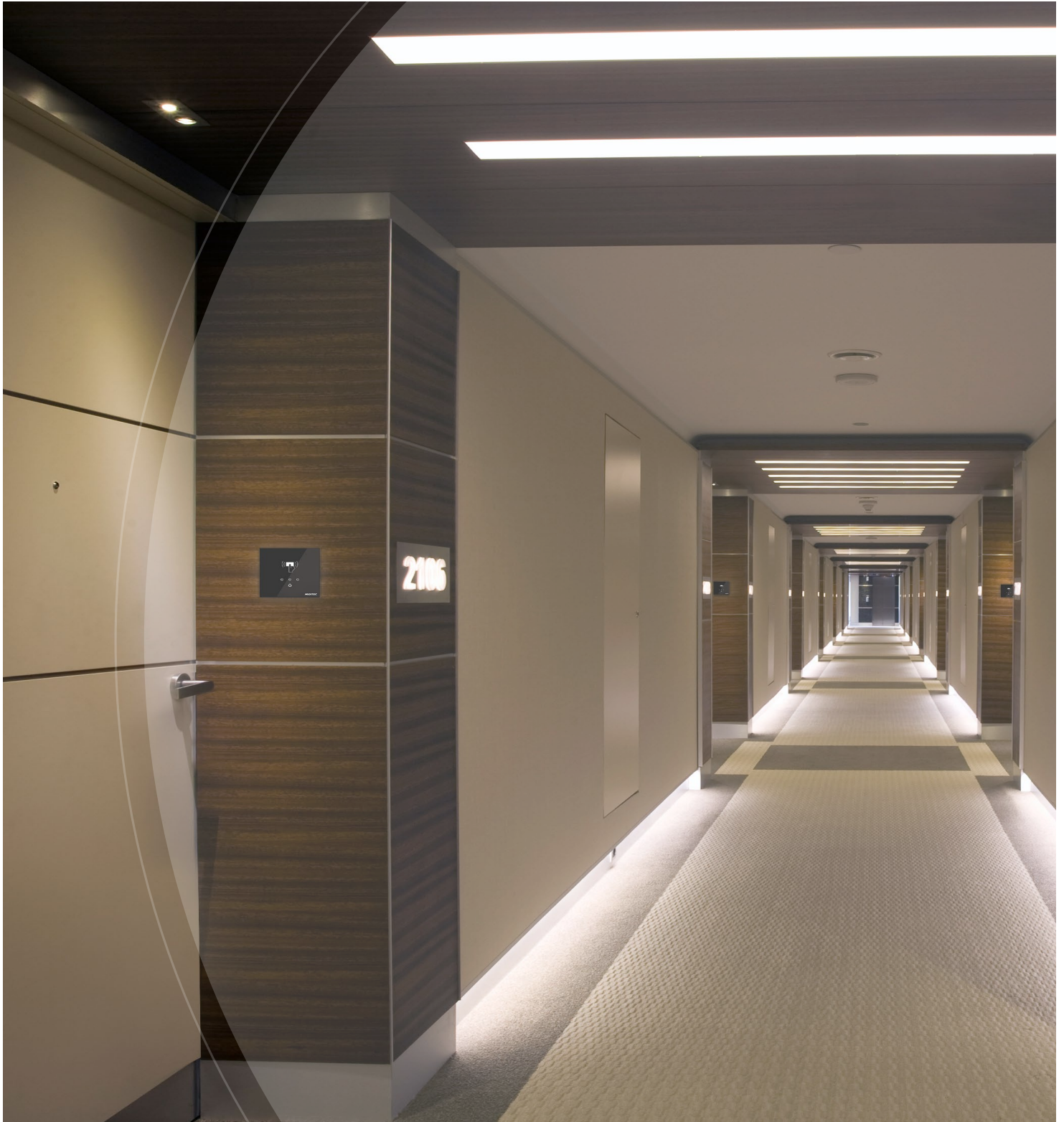

Hotel Hardware

Access Control Units | Access Reader | Door Terminals

Hardware

On- and/or Offline

When it's about integration of access management, time management and building security, online systems are the best choice. The one-time additional expenditure for cabling pays off quickly during daily operation, due to the efficient handling, the functions and evaluation options, as well as the lower follow-up costs.

On the other hand, offline-access systems are usually easier to install and are especially suitable for small objects, less frequented part-areas or the quick and uncomplicated replacement during ongoing hotel business.

MIDITEC serves both worlds and lets them blend smoothly if needed.

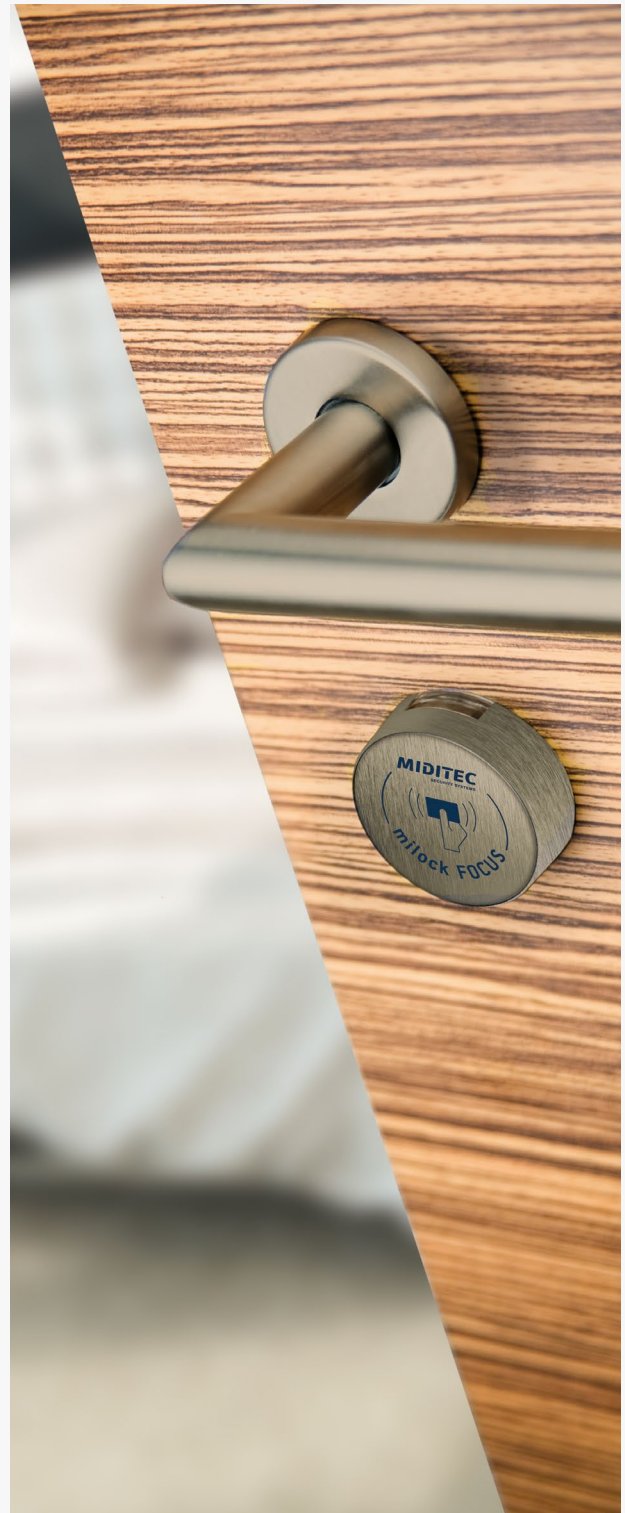

Hardware

The Skyline Brilliance Series

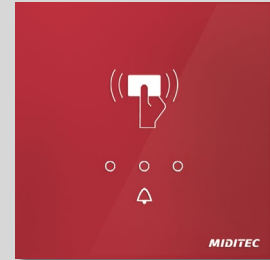
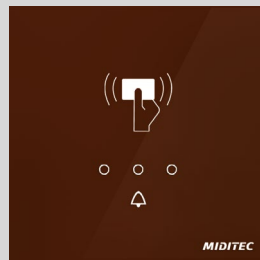
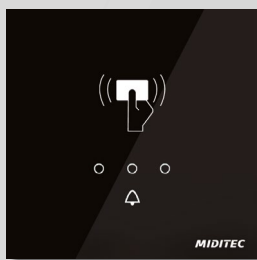

HRC3500 Skyline Brilliance

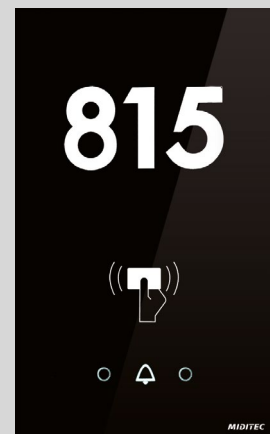
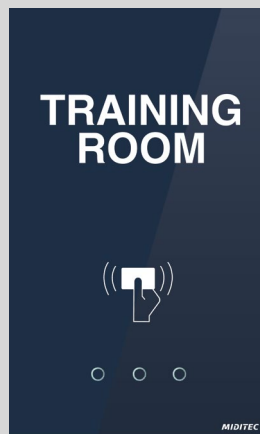
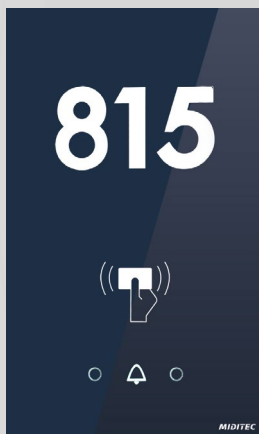

HRC3000 Skyline Brilliance

Glass readers of the Skyline Brilliance series can be manufactured in a wide range of colours. We are happy to realise your individual design ideas.

ACCESS READER MADE OF GLASS

- Contactless reader technology
- DND/MUR indication
- Check Minibar indication
- Capacitive door bell
- Illuminated room number (only with HR/HRC3000)
- Online and offline use supported

Access Readers for Hotel Rooms

Glass Reader with DND/MUR Status Indication

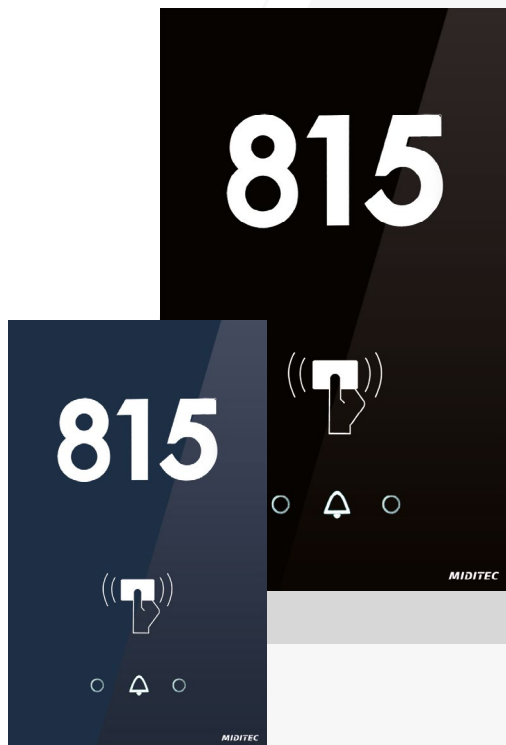

HR3000 SKYLINE BRILLIANCE ACCESS READER

Online/offline reader with contactless MIFARE reader and 2 parameterisable in- and outputs (e.g. 1x door strike, 1x gong, 1x DND switch, 1x MUR switch); glass black; illuminated room number; optional frame in silver or gold, further colours on request; mounting in flush-mounted socket; LEDs for DND (Do Not Disturb) and MUR (Make Up Room); capacitive door bell, RS485 interface (2-wire) for connection to a control unit (option); power supply by external power supply

► YOUR BENEFITS

- Contactless reader technology
- Online operation with HAC5000/32
- Optical status indication provided by multicolour LEDs
- Acoustic status indication by signal generator
- LEDs for DND (Do Not Disturb) and MUR (Make Up Room)
- Capacitive door bell
- Power supply of reader and door strike by external power supply
- Reading range up to 5 cm
- 2 parameterisable inputs (e.g. for DND switch)
- 2 parameterisable outputs (e.g. for door strike)

▼ ACCESS READER

MH5304 HR3000 Skyline Brilliance, MIFARE Classic

▼ ACCESSORIES AND OPTIONS

MH8772 Rack mount power supply unit 30 W

MH8773 Rack mount power supply unit 60 W

Further colour options and frames on request.

Access Readers for Hotel Rooms

Glass Reader with DND/MUR Status Indication for Door Controller

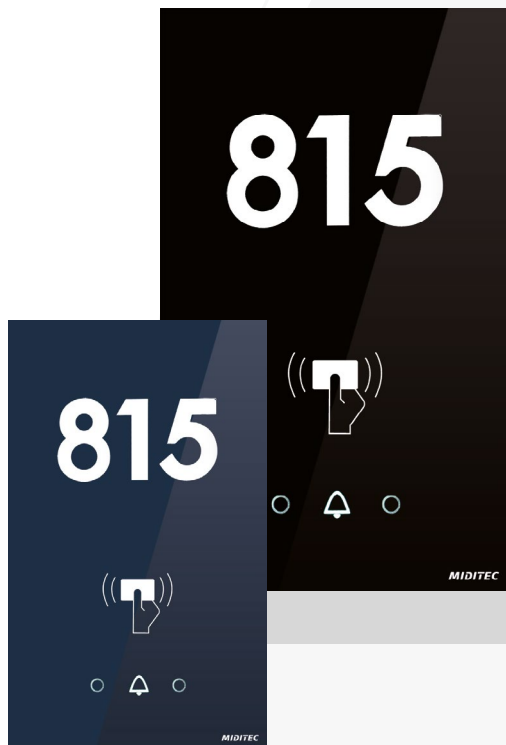

HRC3000 SKYLINE BRILLIANCE ACCESS READER

Online/offline reader with contactless MIFARE reader; glass black, illuminated room number, optional frame in silver or gold, further colours on request; mounting in flush-mounted socket; LEDs for DND (Do Not Disturb) and MUR (Make Up Room), capacitive door bell, RS485 interface (2-wire) for connection to a door controller; power supply via door controller by external power supply

Operation only in combination with an HDC15.

► YOUR BENEFITS

- Contactless reader technology
- Online operation with HAC5000/32
- Optical status indication provided by multicolour LEDs
- Acoustic status indication by signal generator
- LEDs for DND (Do Not Disturb) and MUR (Make Up Room)
- Capacitive door bell
- Power supply of reader, door controller, and door strike by external power supply
- Reading range up to 5 cm

▼ ACCESS READER

MH5305 HRC3000 Skyline Brilliance, MIFARE Classic

Operation only in combination with an HDC15.

▼ ACCESSORIES AND OPTIONS

MH4385 HDC15 Door Controller

MH8772 Rack mount power supply unit 30 W

MH8773 Rack mount power supply unit 60 W

Further colour options and frames on request.

Access Readers for Hotel Rooms

Glass Reader with DND/MUR Status Indication



HR3500 SKYLINE BRILLIANCE ACCESS READER

Online/offline reader with contactless MIFARE reader and 2 parameterisable in- and outputs (e.g. 1x door strike, 1x gong, 1x DND switch, 1x MUR switch); glass black; further colours on request; mounting in flush-mounted socket; LEDs for DND (Do Not Disturb) and MUR (Make Up Room) and Check Minibar; capacitive door bell, RS485 interface (2-wire) for connection to a control unit (option); power supply by external power supply

► YOUR BENEFITS

- Contactless reader technology
- Online operation with HAC5000/32
- Optical status indication provided by multicolour LEDs
- Acoustic status indication by signal generator
- LEDs for DND (Do Not Disturb), MUR (Make Up Room) and Check Minibar
- Capacitive door bell
- Power supply of reader and door strike by external power supply
- Reading range up to 5 cm
- 2 parameterisable inputs (e.g. for DND switch)
- 2 parameterisable outputs (e.g. for door strike)

▼ ACCESS READER

MH5306 HR3500 Skyline Brilliance, MIFARE Classic

▼ ACCESSORIES AND OPTIONS

MH8772 Rack mount power supply unit 30 W

MH8773 Rack mount power supply unit 60 W

Further colour options and frames on request.

Access Readers for Hotel Rooms

Glass Reader with DND/MUR Status Indication for Door Controller



HRC3500 SKYLINE BRILLIANCE ACCESS READER

Online/offline reader with contactless MIFARE reader; glass black; further colours on request; mounting in flush-mounted socket; LEDs for DND (Do Not Disturb) and MUR (Make Up Room) and Check Minibar; capacitive door bell; RS485 interface (2-wire) for connection to a door controller; power supply via door controller by external power supply

Operation only in combination with an HDC15.

► YOUR BENEFITS

- Contactless reader technology
- Online operation with HAC5000/32
- Optical status indication provided by multicolour LEDs
- Acoustic status indication by signal generator
- LEDs for DND (Do Not Disturb), MUR (Make Up Room) and Check Minibar
- Capacitive door bell
- Power supply of reader, door controller, and door strike by external power supply
- Reading range up to 5 cm

▼ ACCESS READER

MH5308 HRC3500 Skyline Brilliance, MIFARE Classic

Operation only in combination with an HDC15.

▼ ACCESSORIES AND OPTIONS

MH4385 HDC15 Door Controller

MH8772 Rack mount power supply unit 30 W

MH8773 Rack mount power supply unit 60 W

Further colour options and frames on request.

Access Readers for Hotel Rooms

Reader with Parameterisable Display



HR620 SKYLINE ACCESS READER WITH DISPLAY

Online/offline reader with contactless MIFARE technology and 2 parameterisable in- and outputs (e.g. 1x door strike, 1x gong, 1x DND switch, 1x MUR switch); display for static or event-related information (e.g. welcome text, DND/MUR or Check Minibar, access or rejection); display of service messages supported, text messages can be programmed via programming card or online; mounting in flush-mounted or surface-mounted socket; door bell; RS485 interface (2-wire) for connection to a control unit (option)

► YOUR BENEFITS

- Contactless MIFARE Classic reader technology
- Online operation with HAC5000/32
- Parameterisable text fields
- Parameterisable room numbers or title lines
- Parameterisable display of DND (Do Not Disturb), MUR (Make Up Room) or Check Minibar as text or icon
- Touch button for door bell
- Display of bell symbol
- Deactivation of bell function in case of DND status and display of respective symbol
- Display of additional service functions for personnel cards
- 2 parameterisable inputs (e.g. for DND switch)
- 2 parameterisable outputs (e.g. for door strike)

▼ HR620

MH8283	HR620, MIFARE Classic, surface-mounted
MH8284	HR620 MIFARE Classic, flush-mounted

▼ ACCESSORIES AND OPTIONS

MH8772	Rack mount power supply unit 30 W
--------	-----------------------------------

Access Readers for Hotel Rooms

Reader with Parameterisable Display for Door Controller



HRC620 SKYLINE ACCESS READER WITH DISPLAY

Online/offline reader with contactless MIFARE technology; display for static or event-related information (e.g. welcome text, DND/MUR or Check Minibar, access or rejection); display of service messages supported, text messages can be programmed via programming card or online; frame available in silver or gold (option); further colours on request; mounting in flush-mounted or surface-mounted socket; door bell; RS485 interface (2-wire) for connection to an HDC15

Operation only in combination with an HDC15.

► YOUR BENEFITS

- Contactless MIFARE Classic reader technology
- Online operation with HAC5000/32
- Parameterisable text fields
- Parameterisable room numbers or title lines
- Parameterisable display of DND (Do Not Disturb), MUR (Make Up Room) and Check Minibar as text or icon
- Touch button for door bell
- Display of bell symbol
- Deactivation of bell function in case of DND status and display of respective symbol
- Display of additional service functions for personnel cards

▼ HRC620

- | | |
|---------------|---|
| MH8229 | HRC620, MIFARE Classic, surface-mounted |
| MH8269 | HRC620 MIFARE Classic, flush-mounted |

Operation only in combination with an HDC15.

▼ ACCESSORIES AND OPTIONS

- | | |
|---------------|--|
| MH4385 | HDC15 Door Controller |
| MH8772 | Rack mount power supply unit 30 W |
| MH8263 | HRC630 SKYLINE Hotel Card Switch with DND, surface-mounted, DND on/off |
| MH8264 | HRC630 SKYLINE Hotel Card Switch with DND, flush-mounted, DND on/off |
| MH8261 | HRC630 SKYLINE Hotel Card Switch with DND/MUR, surface-mounted |
| MH8262 | HRC630 SKYLINE Hotel Card Switch with DND/MUR, flush-mounted |

Access Readers for Hotel Rooms

Access Reader



HR600K SKYLINE MILOCK ACCESS READER

The HR600K offers the following functions: The HR600K has 2 parameterisable inputs and outputs (e.g. 1x door strike, 1x gong, 1x DND switch, 1x MUR switch); door opening after reading a valid card (if door strike is connected or optionally with wireless lock modification); ringing when activating the capacitive door bell (if gong is connected). Optionally, the HR600K Skyline milock reader can be operated for online functionality with the HAC5000/32 control unit.

► YOUR BENEFITS

- Contactless MIFARE Classic reader technology
- Online operation with serial control unit HAC5000/32
- Offline operation supported
- Reading range up to 5 cm
- Power supply by power supply unit
- RS485 interface
- Optical status indication provided by LED
- Capacitive, blue illuminated bell touch button
- LED display of DND and MUR
- Deactivation of bell function in case of DND status and display of respective symbol
- 2 parameterisable inputs (e.g. for DND switch)
- 2 parameterisable outputs (e.g. for door strike)

▼ HR600K

MH8285	HR600K MIFARE Classic, surface-mounted
MH8286	HR600K MIFARE Classic, flush-mounted

▼ ACCESSORIES AND OPTIONS

MH8772	Rack mount power supply unit 30 W
MH8773	Rack mount power supply unit 60 W
MH4728	H940 BJE milock Door Gong For further colour options, see „Hotel Accessories“.

Access Reader for Hotel Rooms

Access Reader for Door Controller



HRC600K SKYLINE MILOCK ACCESS READER

The HRC600K Skyline milock hotel reader is used in connection with the door controller HDC15. For online functionality it can optionally be operated with the HAC5000/32 control unit. The HRC600K offers the following functions: door opening after reading a valid card (potential-free relay at the door controller and connected door strike); ringing when activating the capacitive door bell (potential-free relay at the door controller and connected gong).

Operation only in combination with an HDC15.

► YOUR BENEFITS

- Contactless MIFARE Classic reader technology
- Reader as system component with HDC15 door controller (control unit)
- Online operation with serial control unit HAC5000/32
- Offline operation (without serial control unit) supported
- Reading range up to 5 cm
- Power supply by power supply unit
- RS485 interface
- Optical status indication provided by LED
- Capacitive, blue illuminated bell touch button
- LED display of DND and MUR
- Deactivation of bell function in case of DND status

▼ HRC600K

MH8287	HRC600K MIFARE Classic, surface-mounted
MH8288	HRC600K MIFARE Classic, flush-mounted

▼ ACCESSORIES AND OPTIONS

MH8772	Rack mount power supply unit 30 W
MH8773	Rack mount power supply unit 60 W
MH4385	HDC15 Door Controller
MH4728	H940 BJE milock Door Gong For further colour options, see „Hotel Accessories“.

Access Reader for Hotel Room

Access Reader for Door Controller



HRC420 BJE ACCESS READER

Online/offline reader with contactless MIFARE reader for Busch-Jaeger switch programmes; standard: future linear in studio white, mounting in flush-mounted socket; status indication for DND (Do Not Disturb) and MUR (Make Up Room), door bell button; RS485 interface (2-wire) for connection to a door controller, power supply via door controller by external power supply

Operation only in combination with an HDC15.

► YOUR BENEFITS

- Contactless reader technology
- Online operation with HAC5000/32
- Optical status indication provided by multicolour LEDs
- Acoustic status indication by signal generator
- LEDs for DND (Do Not Disturb), MUR (Make Up Room)
- Integrated door bell button
- Power supply of reader, door controller and door strike by external power supply
- Reading range up to 5 cm

▼ ACCESS READER

MH8225 HRC420, MIFARE Classic

Operation only in combination with an HDC15.
For further colour options, see „Hotel Accessories“.

▼ ACCESSORIES AND OPTIONS

MH4385 HDC15 Door Controller
MH8772 Rack mount power supply unit 30 W
MH8773 Rack mount power supply unit 60 W
MH8245 HC920 BJE milock DND/MUR switch

Status Indication for Hotel Rooms

DND/MUR Status Indication



H420 BJE STATUS INDICATOR

Status indicator for DND (Do Not Disturb) and MUR (Make Up Room) for Busch-Jaeger switch programmes; standard: future linear studio white; mounted in flush-mount socket; door bell button; RS485 interface (2-wire) for connection to an HDC920 BJE; power supply via door controller by external power supply

Operation only in combination with an HDC920 BJE.

► YOUR BENEFITS

- Optical status indication via LED depending on the model for DND (Do Not Disturb) and MUR (Make Up Room)
- Integrated door bell button
- Voltage supply by external power supply

▼ BJE STATUS INDICATION

MH8242 H420 BJE DND/MUR status indication

Operation only in combination with an HDC920 BJE.
For further colour options, see „Hotel Accessories“.

▼ ACCESSORIES AND OPTIONS

MH8272	HDC920 BJE milock DND on/off switch
MH8251	HDC920 BJE milock DND/MUR switch
MH4728	H940 BJE milock Door Gong
MH8772	Rack mount power supply unit 30 W
MH8773	Rack mount power supply unit 60 W

Door Terminals for Hotel Rooms

milock Wireless Lock

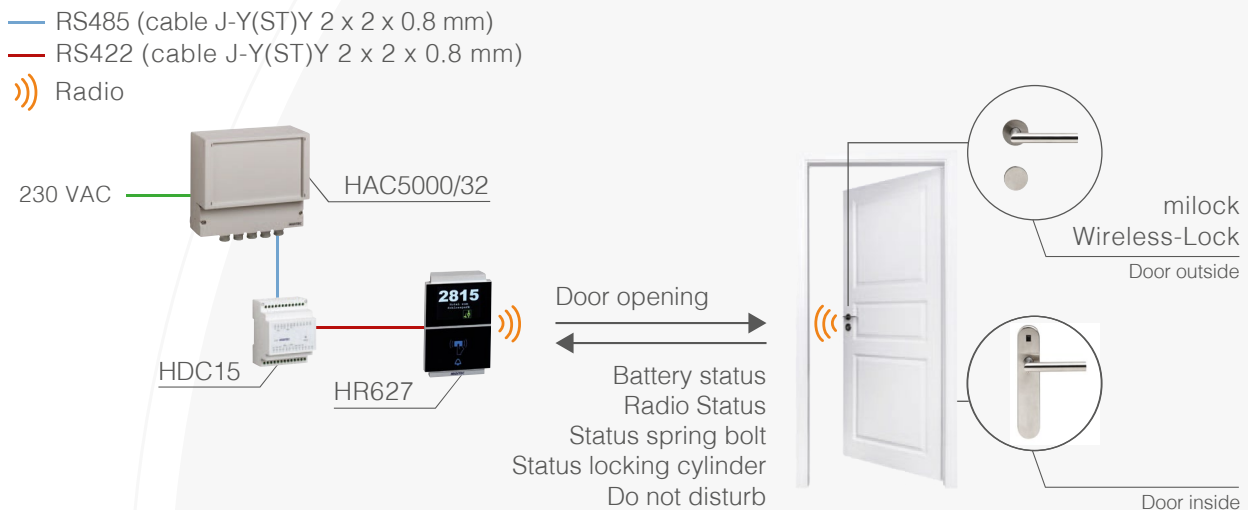

MILOCK WIRELESS LOCK

Electronic wireless lock for RFID-reader

► YOUR BENEFITS

- Wireless - replaces wired door strikes
- Door opening via radio signal for online/offline reader
- Practicable pairing procedure with support of the construction sites function (no prior system configuration necessary)
- Door-sided, battery-buffered slave unit and reader-sided master unit
- Doorpattern inside: long plate with battery compartment, radio receiver
- Doorpattern outside: handle
- Automatic, manual and remote-controlled reading of battery status (online operation necessary)
- Connection status is evaluated in MTZ® BS (online operation necessary)
- Alarm notification in case of longer lasting wireless interruption (online operation necessary)
- Emergency opening supported by inserting a mechanical cylinder
- AES128 bit encryption
- Man-In-The-Middle-Protection
- Battery life > 2 years
4 AA lithium ion batteries

Door Terminals for Hotel Rooms

milock Wireless Lock

▼ MILOCK WIRELESS LOCK

MF1006	milock Wireless Lock, stainless steel matt brushed, MIFARE Classic, mortise lock backset 55 mm
MF1007	milock Wireless Lock with Privacy, stainless steel matt brushed, MIFARE Classic, mortise lock backset 55 mm
MF1008	milock Wireless Lock with monitoring contact, stainless steel matt brushed, MIFARE Classic, mortise lock backset 55 mm
MF1009	milock Wireless Lock with Privacy with monitoring contact, stainless steel matt brushed, MIFARE Classic, mortise lock backset 55 mm

▼ MORTISE LOCK

MF1011	Mortise lock backset 60 mm
MF1012	Mortise lock backset 65 mm
MF1013	Mortise lock backset 80 mm

▼ MORTISE LOCK WITH MONITORING CONTACT

MF1016	Mortise lock with monitoring contact backset 60 mm
MF1017	Mortise lock with monitoring contact backset 65 mm
MF1018	Mortise lock with monitoring contact backset 80 mm

▼ DOOR HANDLE TYPES

MF1020	Door handle type MIDITEC Standard L, stainless steel matt brushed
MF1021	Door handle type L-Panic, stainless steel matt brushed
MF1022	Door handle type C, stainless steel matt brushed
MF1023	Door handle type U, stainless steel matt brushed

For further information on door handle types refer to the pages 29/30.

▼ ACCESS READER

MF2000	HR607 for milock Wireless Lock, surface-mounted
MF2001	HR607 for milock Wireless Lock, flush-mounted
MF2002	HRC607 for milock Wireless Lock, surface-mounted
MF2003	HRC607 for milock Wireless Lock, flush-mounted
MF2004	HR607K for milock Wireless Lock, surface-mounted with bell button
MF2005	HR607K for milock Wireless Lock, flush-mounted with bell button
MF2006	HRC607K for milock Wireless Lock, surface-mounted with bell button
MF2007	HRC607K for milock Wireless Lock, flush-mounted with bell button
MF2008	HR627 for milock Wireless Lock, surface-mounted
MF2009	HR627 for milock Wireless Lock, flush-mounted
MF2010	HRC627 for milock Wireless Lock, surface-mounted
MF2011	HRC627 for milock Wireless Lock, flush-mounted
MF2016	HR3007 Skyline Brilliance for milock Wireless Lock
MF2017	HRC3007 Skyline Brilliance for milock Wireless Lock
MF2018	HR3507 Skyline Brilliance for milock Wireless Lock
MF2019	HRC3507 Skyline Brilliance for milock Wireless Lock

Door Terminals for Hotel Rooms

milock Focus



Door outside



MILOCK FOCUS

Mechatronic door lock system

Mortise lock:

Suitable for single-winged doors with handles according to DIN EN 179; DIN 18250; a mechatronic door lock system with battery supply and integrated R/W MIFARE reader; compatible with the MIDITEC handle series; with a latch bolt, round forend, prepared for profile cylinder including 2 forend screws.

Antenna and battery compartment:

Contactless MIFARE antenna; on the inside of the door there is a battery compartment in the plate in the colours silver or brass.

Door handle:

Please select the door handles from the available MIDITEC series.

► YOUR BENEFITS

- Contactless MIFARE Classic reader (outside)
- From the outside the fitting can only be opened via electronic authorisation
- Visual and acoustic system status indication (e.g., locked status, battery replacement required)
- Storage of the last 1,500 bookings
- Programming via system cards
- Flexible time zone management and control
- Management of access rights via group organisation (256 locking groups, 16 weekly programmes per group)
- Authorisation via card
- Blacklist for blocked cards can be generated
- Battery status can be written on card
- Up to 4 time zones per day
- Door release time freely selectable
- Automatic daylight-saving time adjustment
- Reading range up to 1.5 cm
- Easy installation

Door Terminals for Hotel Rooms

milock Focus

▼ MILOCK FOCUS

MF1000	milock Focus, stainless steel matt brushed, MIFARE Classic, mortise lock backset 55 mm
MF1001	milock Focus with Privacy, stainless steel matt brushed, MIFARE Classic, mortise lock backset 55 mm
MF1004	milock Focus with monitoring contact, stainless steel matt brushed, MIFARE Classic, mortise lock backset 55 mm
MF1005	milock Focus with Privacy with monitoring contact, stainless steel matt brushed, MIFARE Classic, mortise lock backset 55 mm

▼ MORTISE LOCK

MF1011	Mortise lock backset 60 mm
MF1012	Mortise lock backset 65 mm
MF1013	Mortise lock backset 80 mm

▼ MORTISE LOCK WITH MONITORING CONTACT

MF1016	Mortise lock with monitoring contact backset 60 mm
MF1017	Mortise lock with monitoring contact backset 65 mm
MF1018	Mortise lock with monitoring contact backset 80 mm

▼ PROFILE HALF CYLINDER

MH4806	Profile half cylinder 30-10 with security card
MH4807	Profile half cylinderr 35-10 with security card

A profile half cylinder body with the required dimensions of the door has to be ordered.

▼ DOOR HANDLE TYPES

MF1020	Door handle type MIDITEC Standard L, stainless steel matt brushed
MF1021	Door handle type L-Panic, stainless steel matt brushed
MF1022	Door handle type C, stainless steel matt brushed
MF1023	Door handle type U, stainless steel matt brushed

For further information on door handle types refer to the pages 29/30.

Door Terminals for Hotel Rooms

Door Handle Types milock Focus | milock Wireless Lock

OVERVIEW DOOR HANDLE TYPES STAINLESS STEEL



MF1020

Door handle type MIDITEC Standard L,
stainless steel matt brushed



MF1021

Door handle type L-Panic,
stainless steel matt brushed



MF1022

Door handle type C,
stainless steel matt brushed



MF1023

Door handle type U,
stainless steel matt brushed

▼ DOOR HANDLE TYPES

MF1000

milock Focus, stainless steel matt
brushed, MIFARE Classic, mortise lock
backset 55 mm

MF1006

milock Wireless Lock, stainless steel
matt brushed, MIFARE Classic, mortise
lock backset 55 mm

For further versions, please, refer to our price list.

MIDITEC STANDARD PACKAGE

Basic fitting



Only milock Focus

Outside

Inside



With Privacy

Room Control for Hotel Rooms

The Bedside Panel



SKYLINE - OUTSTANDING DESIGN

The requirements related to access readers, switches and displays in hotels are high: They have to function reliably, be maintenance-friendly and easy to operate. Furthermore, they have to be visually appealing and harmonise optically with their respective environment.

In close cooperation with renowned product designers the MIDITEC engineers have developed a completely new product family named SKYLINE in 2012. SKYLINE convinces with attractive design, durable materials, versatile fields of applications and high profitability. All modules do without mechatronic components. And with surfaces free of burs and with unambiguous labelling they offer a long-term easy and secure handling by the user even in case of high use.

Due to various materials, colours and fonts the SKYLINE components can additionally be optically adapted to diverse design concepts.

BEDSIDE PANEL

By means of the bedside panel the hotel guest can control different light scenarios, DND/MUR, blinds, curtains, etc. centrally with the bedside panel. The key assignment can be parameterised via the software.

Room Control for Hotel Rooms

The Skyline Bedside Panel



HC666 BEDSIDE PANEL

Bedside panel for light scenario control in combination with a door controller and a light extension, touch function, status indication via LED; flush- or surface-mounted; Skyline design

► YOUR BENEFITS

- Optical feedback on key activation and set modes via light intensity and key colour
- Automatic display dimming depending on the ambient lightning
- Proximity detection for illumination of the keys
- Switching of single lights or light scenarios
- Individual key colours and icons on request
- Up to 6 keys realisable

▼ BEDSIDE PANEL

MH9127 HC666 Skyline Bedside Panel

Operation only in combination with an HDC15 and an HDCL.

▼ ACCESSORIES AND OPTIONS

MH4385 HDC15 Door Controller

MH4726 HDCL Light Extension

Room Control for Hotel Rooms

The Bedside Panel



HC3506 BEDSIDE PANEL

Bedside panel for light scenario control in combination with a door controller and a light extension, touch function, status indication via LED; glass black; further colours on request, flush-mounted

► YOUR BENEFITS

- Optical feedback on key activation and set modes via light intensity and key colour
- Automatic display dimming depending on the ambient lightning
- Proximity detection for illumination of the keys
- Switching of single lights or light scenarios
- Individual key colours and icons on request
- Up to 6 keys realisable
- Cleaning function to avoid key activation while cleaning the display

▼ BEDSIDE PANEL

MH9128 HC3506 Bedside Panel

Operation only in combination with an HDC15 and an HDCL.

▼ ACCESSORIES AND OPTIONS

MH4385 HDC15 Door Controller

MH4726 HDCL Light Extension

Room Control for Hotel Rooms

The Bedside Panel

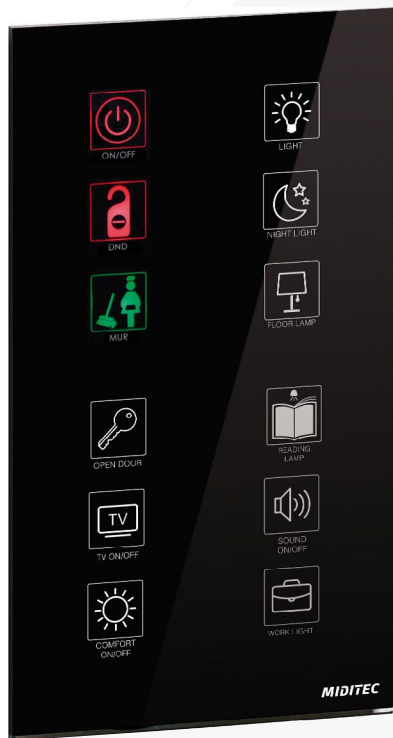

HC3512 BEDSIDE PANEL

Bedside panel for light scenario control in combination with a door controller and a light extension, touch function, status indication via LED; glass black; further colours on request, flush-mounted

► YOUR BENEFITS

- Optical feedback on key activation and set modes via light intensity and key colour
- Automatic display dimming depending on the ambient lightning
- Proximity detection for illumination of the keys
- Switching of single lights or light scenarios
- Individual key colours and icons on request
- Up to 12 keys realisable
- Cleaning function to avoid key activation while cleaning the display

▼ BEDSIDE PANEL

MH9129 HC3512 Bedside Panel with 12 touch keys

Operation only in combination with an HDC15 and an HDCL.

▼ ACCESSORIES AND OPTIONS

MH4385 HDC15 Door Controller

MH4726 HDCL Light Extension

Room Control for Hotel Rooms

The Skyline Temperature Control



HC630 TEMPERATURE CONTROL

Air conditioning control unit for ventilation and temperature control in combination with a door controller and a climate extension; touch function; status indication via LED; flush- or surface-mounted; Skyline design

► YOUR BENEFITS

- Display of the measured room temperature in °C
- Adjustment of target temperature via +/- keys
- Visual feedback on key activation and set modes via light intensity and key colour
- Automatic display dimming depending on the ambient lightning
- Proximity detection for illumination of the keys
- 3 fan stages adjustable per key activation
- Automatic fan-stage selection via automatic key
- Economy mode for energy-saving standard settings
- Cleaning function to avoid key activation while cleaning the display

▼ TEMPERATURE CONTROL

MH9130 HC630 Skyline Temperature Control

Operation only in combination with an HDC15 and an HDCC.

▼ ACCESSORIES AND OPTIONS

MH4385 HDC15 Door Controller

MH9132 HDCC Climate Extension

Room Control for Hotel Rooms

The Temperature Control



HC3530 TEMPERATURE CONTROL

Air conditioning control unit for ventilation and temperature control in combination with a door controller and a climate extension; touch function; status indication via LED; acoustic feedback; glass black; further colours on request; flush-mounted

► YOUR BENEFITS

- Display of the measured room temperature in °C
- Adjustment of target temperature via +/- keys
- Visual feedback on key activation and set modes via light intensity and key colour
- Automatic display dimming depending on the ambient lightning
- Proximity detection for illumination of the keys
- 3 fan stages adjustable per key activation
- Automatic fan-stage selection via automatic key
- Economy mode for energy-saving standard settings
- Cleaning function to avoid key activation while cleaning the display

▼ TEMPERATURE CONTROL

MH9131 HC3530 Temperature Control

Operation only in combination with an HDC15 and an HDCC.

▼ ACCESSORIES AND OPTIONS

MH4385 HDC15 Door Controller

MH9132 HDCC Climate Extension

Room Control for Hotel Rooms

The Intelligent Hotel Card Switch



HRC630 SKYLINE HOTELCARD SWITCH WITH DND/MUR

Release of electrical circuits in a defined range for light and electronical devices such as air conditioning systems, TV, etc.; card type identification for guest/personnel cards by means of MIFARE Classic reader technology; touch function for DND/MUR indication; status indication via LED; acoustic feedback; flush- or surface-mounted; Skyline design

Operation only in combination with an HDC15 and an HRC reader.

► YOUR BENEFITS

- Optical status indication via multicolour LED for DND (Do Not Disturb) and MUR (Make Up Room)
- Integrated keys for DND and MUR
- MIFARE RFID card reader
- Power supply via door controller by external power supply
- Differentiation between guest and personnel cards

▼ HRC630

- | | |
|--------|--|
| MH8261 | HRC630 SKYLINE Hotel Card Switch with DND/MUR, surface-mounted |
| MH8262 | HRC630 SKYLINE Hotel Card Switch with DND/MUR, flush-mounted |

Operation only in combination with an HDC15 and an HRC reader.

▼ ACCESSORIES AND OPTIONS

- | | |
|--------|-----------------------|
| MH4385 | HDC15 Door Controller |
|--------|-----------------------|

Room Control for Hotel Rooms

The Intelligent Hotel Card Switch



HRC630 SKYLINE HOTEL CARD SWITCH WITH DND ON/OFF

Release of electrical circuits in a defined range for light and electronical devices such as air conditioning systems, TV, etc.; card type identification for guest/personnel cards by means of MIFARE Classic reader technology; touch function for DND indication; status indication via LED; acoustic feedback; flush- or surface-mounted; Skyline design

Operation only in combination with an HDC15 and an HRC reader.

► YOUR BENEFITS

- Optical status indication via multicolour LED for DND (Do Not Disturb) on/off
- Integrated key for DND
- MIFARE RFID card reader
- Power supply via door controller by external power supply
- Differentiation between guest and personnel cards

▼ HRC630

- | | |
|---------------|---|
| MH8263 | HRC630 SKYLINE Hotel Card Switch with DND on/off, surface-mounted |
| MH8264 | HRC630 SKYLINE Hotel Card Switch with DND on/off, flush-mounted |

Operation only in combinatin with an HDC15 and an HRC reader.

▼ ACCESSORIES AND OPTIONS

- | | |
|---------------|-----------------------|
| MH4385 | HDC15 Door Controller |
|---------------|-----------------------|

Room Control for Hotel Rooms

DND/MUR Switch



HC920 BJE MILOCK DND/MUR SWITCH

Hotel room switch for activating the outdoor indication of DND (Do Not Disturb) and MUR (Make Up Room); for Busch-Jaeger switch programmes; standard: future linear in studio white; flush-mounted; RS495 interface (2-wire) for connection to a door controller; power supply via door controller by external power supply



HC920 BJE MILOCK DND ON/OFF SWITCH

Hotel room switch for activating the outdoor indication of DND (Do Not Disturb); for Busch-Jaeger switch programmes; standard: future linear in studio white; flush-mounted; RS495 interface (2-wire) for connection to a door controller; power supply via door controller by external power supply

► YOUR BENEFITS

- Optical status indication via multicolour LED for DND (Do Not Disturb) and MUR (Make Up Room)
- Integrated push-button for DND or DND/MUR
- Power supply via door controller by external power supply

▼ DND/MUR SWITCH

- | | |
|---------------|--|
| MH8245 | HC920 BJE milock DND / MUR switch |
| MH8244 | HC920 BJE milock DND / MUR switch with relay outputs for DND and MUR |

▼ ON/OFF SWITCH

- | | |
|---------------|---|
| MH8271 | HC920 BJE milock DND / MUR switch with DND on/off |
| MH8277 | HC920 BJE milock DND / MUR switch with relay outputs for DND on/off |

Further colour options on page 41.

Room Control for Hotel Rooms

DND/MUR Switch



HDC920 BJE MILOCK DND/MUR SWITCH

Hotel room switch for activating the outdoor indication of DND (Do Not Disturb) and MUR (Make Up Room); for Busch-Jaeger switch programmes; standard: future linear in studio white; flush-mounted; RS495 interface (2-wire) for connection to a door controller; power supply via door controller by external power supply



HDC920 BJE MILOCK DND ON/OFF SWITCH

Hotel room switch for activating the outdoor indication of DND (Do Not Disturb); for Busch-Jaeger switch programmes; standard: future linear in studio white; flush-mounted; RS495 interface (2-wire) for connection to a door controller; power supply via door controller by external power supply

► YOUR BENEFITS

- Optical status indication via multicolour LED for DND (Do Not Disturb) and MUR (Make Up Room)
- Integrated push-button for DND or DND/MUR
- Power supply via door controller by external power supply

▼ DND/MUR SWITCH

MH8251 HDC920 BJE milock DND/MUR switch

▼ ON/OFF SWITCH

MH8272 HDC920 BJE milock DND on/off switch

Room Control for Hotel Rooms

Energy-Saving Terminal

With the H910 BJE milock energy-saving terminals you can save energy within the room. The electrical circuit will only be released when inserting the card into the terminal. Without card the electrical circuit is interrupted and no power supply is available in the room.



H910 BJE MILOCK ENERGY-SAVING TERMINAL

Release of electrical circuit for light and electronical devices (air conditioning systems, TV, etc.) by inserting a milock RFID card; flush-mounted; only for indoor use; no card reading; Busch-Jaeger switch programme; standard: future linear in studiowhite

▼ **ENERGY-SAVING TERMINAL**

MH8246

H910 BJE milock Energy-Saving Terminal

Further colour options on page 41.

Room Control for Hotel Rooms

Energy-Saving Terminal

With the HR910 BJE and the HRC910 BJE milock energy-saving terminals you can save energy within the room. The electrical circuit will only be released when inserting the card into the terminal. Without card the electrical circuit is interrupted and no power supply is available in the room.



HRC910 BJE MILOCK ENERGY-SAVING TERMINAL WITH READER

Release of electrical circuit for light and electronic devices (air conditioning systems, TV, etc.) by inserting a milock RFID card; flush-mounted; only for indoor use; Busch-Jaeger switch programme; standard: future linear in studiowhite

HR910 BJE MILOCK ENERGY-SAVING TERMINAL WITH READER AND RELAY OUTPUT

Release of electrical circuit for light and electronic devices (air conditioning systems, TV, etc.) by inserting a milock RFID card; flush-mounted; only for indoor use; with relay output; Busch-Jaeger switch programme; standard: future linear in studiowhite

▼ **ENERGY-SAVING TERMINAL**

MH8248	HRC910 BJE milock Energy-Saving Terminal
MH8273	HR910 BJE milock Energy-Saving Terminal with relay output

Further colour options on page 41.

Room Control for Hotel Room

Door Gong



H940 BJE MILOCK DOOR GONG

Door gong for hotel rooms; for Busch-Jaeger switch programmes; standard: future linear in studio white; power supply via door controller by external power supply

► YOUR BENEFITS

- Electronic three-tone gong
- Tone frequency and volume adjustable

▼ DOOR GONG

MH4728

H940 BJE Door Gong



Hotel Hardware

Wirtschaft | Zutrittsmanagement | Sicherheit
Access Units | Access Reader | Door Terminals

Hotel Hardware

Access Control Unit



HAC5000/32 MILOCK HOTEL CONTROL UNIT

Access control unit with two RS485 interfaces (2-wire) for connection of up to 2 x 16 hotel readers (bus system); connection to server or PC via Ethernet / RS485 interface; plastic casing; service port for external service reader (software) for diagnosis/operation; only with MTZ® milock Hotel Access (online)

FUNCTIONS: Access; predefined door monitoring of up to 32 doors

► YOUR BENEFITS

- Storage of up to 7,000 events (optional up to 150,000)
- Data is kept for at least 2 months (lithium battery)
- 512 KByte SRAM (max. 4 MB)
- Automatic recognition of connected readers
- External 12 V operation supported
- External power supply of readers required

▼ MILOCK HOTEL CONTROL UNIT

MH4464	HAC5000/32, plastic casing, Ethernet (100 Mbit) / RS485 interface
---------------	--

Hotel Hardware

Glas Reader with DND / MUR Status Indication



HR3500 SKYLINE BRILLIANCE ACCESS READER WITHOUT BELL

Online/offline reader with contactless MIFARE reader and 2 parameterisable inputs and outputs; glass black; further colours on request; flush-mounted; LEDs for DND (Do Not Disturb), MUR (Make Up Room) and Check Minibar; RS485 interface (2-wire) for connection to a control unit; power supply by external power supply

► YOUR BENEFITS

- Contactless reader technology
- Online operation with HAC5000/32
- Optical status indication provided by multicolor LEDs
- Acoustic status indication by signal generator
- LEDs for DND (Do Not Disturb), MUR (Make Up Room) and Check Minibar
- Power supply of reader and door strike by external power supply
- Reading range up to 5 cm
- 2 parameterisable inputs (e.g. for DND switch)
- 2 parameterisable outputs (e.g. for door strike)

▼ ACCESS READER

MH5307 HR3500 Skyline Brilliance without bell, MIFARE Classic

▼ ACCESSORIES AND OPTIONS

MH8772 Rack mount power supply unit 30 W
MH8773 Rack mount power supply unit 60 W

Further colour options and frames on request.

Hotel Hardware

Glass Reader with DND / MUR Status Indication for Door Controller



HRC3500 SKYLINE BRILLIANCE ACCESS READER WITHOUT BELL

Online/offline reader with contactless MIFARE reader; glass black; further colours on request; flush-mounted; LEDs for DND (Do Not Disturb), MUR (Make Up Room) and Check Minibar; capacitive door bell; RS485 interface (2-wire) for connection to a door controller; power supply via door controller by external power supply

Operation only in combination with an HDC15.

► YOUR BENEFITS

- Contactless reader technology
- Online operation with HAC5000/32
- Optical status indication provided by multicolor LEDs
- Acoustic status indication by signal generator
- LEDs for DND (Do Not Disturb), MUR (Make Up Room) and Check Minibar
- Power supply of reader, door controller and door strike by external power supply
- Reading range up to 5 cm

▼ ACCESS READER

MH5309 HRC3500 Skyline Brilliance without bell, MIFARE Classic

Operation only in combination with an HDC15.

▼ ACCESSORIES AND OPTIONS

MH4385 HDC15 Door Controller
MH8772 Rack mount power supply unit 30 W
MH8773 Rack mount power supply unit 60 W

Hotel Hardware Access Reader

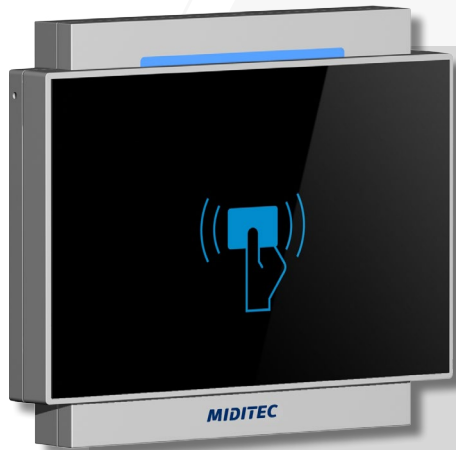

HR600 ACCESS READER SURFACE-MOUNTED / FLUSH-MOUNTED

The HR600 has 2 parameterisable in- and outputs each (e.g. 1x door strike, door opening after reading a valid card); for online functionality the HR600 can optionally be operated at the control unit HAC5000/32

► YOUR BENEFITS

- Contactless MIFARE Classic reader technology
- Online operation with serial control unit HAC5000/32
- Offline operation supported (without serial control unit)
- Optical status indication provided by multicolor LEDs
- Acoustic status indication by signal generator
- Permanent door release
- Power supply of reader and door strike by external power supply
- Reading range up to 5 cm

▼ ACCESS READER

MH8731	HR600, MIFARE Classic, surface-mounted
MH8736	HR600, MIFARE Classic, flush-mounted

▼ ACCESSORIES AND OPTIONS

MH8772	Rack mount power supply unit 30 W
MH8773	Rack mount power supply unit 60 W

Hotel Hardware

Access Reader for Door Controller

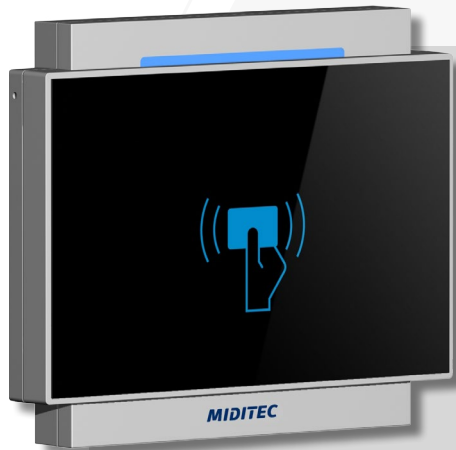

HRC600 ACCESS READER SURFACE-MOUNTED / FLUSH-MOUNTED

The HRC600 hotel reader is used in combination with the door controller HDC15. For online functionality, the HDC15 can optionally be operated with the control unit HAC5000/32. The HRC600 offers the following functions: door opening after reading a valid card (potential-free relay at the door controller and connected door strike).

Operation only in combination with an HDC15.

► YOUR BENEFITS

- Contactless MIFARE Classic reader technology
- Reader as system component with HDC15 Door Controller
- Online operation with serial control unit HAC5000/32
- Offline operation supported (without serial control unit)
- Optical status indication provided by multicolor LEDs
- Acoustic status indication by signal generator
- Permanent door release
- Power supply of reader, door controller and door strike by external power supply
- Reading range up to 5 cm

▼ ACCESS READER

- | | |
|---------------|---|
| MH8732 | HRC600, MIFARE Classic, surface-mounted |
| MH8737 | HRC600, MIFARE Classic, flush-mounted |

Operation only in combination with an HDC15.

▼ ACCESSORIES AND OPTIONS

- | | |
|---------------|-----------------------------------|
| MH4385 | HDC15 Door Controller |
| MH8772 | Rack mount power supply unit 30 W |
| MH8773 | Rack mount power supply unit 60 W |

Hotel Hardware Access Reader

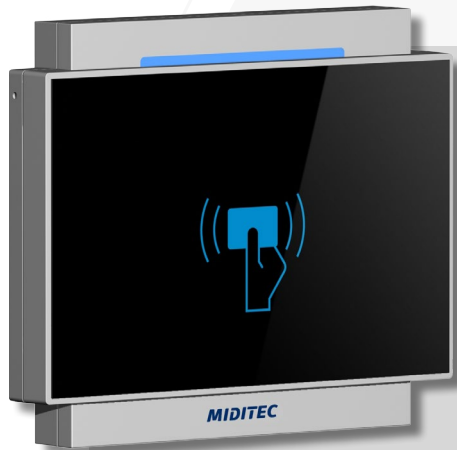

HR605 ACCESS READER FOR OUTDOOR USE

Online/offline reader with contactless MIFARE reader; RS485 interface (2-wire) for connection to a control unit (optional); power supply by external power supply

► YOUR BENEFITS

- Contactless reader technology
- Online operation with serial control unit HAC5000/32
- Optical status indication provided by multicolor LEDs
- Acoustic status indication by signal generator
- Permanent door release
- Power supply of reader and door strike by external power supply
- Reading range up to 5 cm

▼ ACCESS READER

MH5302 HR605, MIFARE Classic, surface-mounted for outdoor use

▼ ACCESSORIES AND OPTIONS

MH8772 Rack mount power supply unit 30 W
MH8773 Rack mount power supply unit 60 W

Hotel Hardware

Access Reader for Door Controller

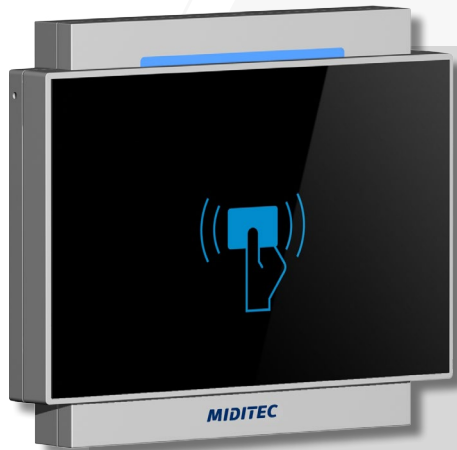

HRC605 ACCESS READER FOR OUTDOOR USE

Online/offline reader with contactless MIFARE reader; RS485 interface (2-wire) for connection to a door controller; power supply via door controller by external power supply

Operation only in combination with an HDC15.

► YOUR BENEFITS

- Contactless reader technology
- Online operation with HAC5000/32
- Optical status indication provided by multicolor LEDs
- Acoustic status indication by signal generator
- Permanent door release
- Power supply of reader, door controller and door strike by external power supply
- Reading range up to 5 cm

▼ ACCESS READER

MH9119 HRC605, MIFARE Classic, surface-mounted

Operation only in combination with an HDC15.

▼ ACCESSORIES AND OPTIONS

MH4385 HDC15 Door Controller
MH8772 Rack mount power supply unit 30 W
MH8773 Rack mount power supply unit 60 W

Hotel Hardware

Access Reader with DND / MUR Status Indication for Door Controller



HRC400 BJE ACCESS READER

Online/offline reader with contactless reader technology for Busch-Jaeger switch programmes; standard: future linear studio white; flush-mounted; RS485 interface (2-wire) for connection to a door controller; power supply via door controller by external power supply

Operation only in combination with an HDC15.

► YOUR BENEFITS

- Contactless reader technology
- Online operation with HAC5000/32
- Optical status indication provided by multicolor LED
- Acoustic status indication by signal generator
- Reading range up to 5 cm
- Power supply of reader, door controller and door strike by external power supply

▼ ACCESS READER

MH8226 HRC400 BJE, MIFARE Classic

Operation only in combination with an HDC15.
For further colour options, see "Hotel Accessories".

▼ ACCESSORIES AND OPTIONS

MH4385 HDC15 Door Controller

MH8772 Rack mount power supply unit 30 W

MH8773 Rack mount power supply unit 60 W

Hotel Hardware

Access Reader with DND / MUR Status Indication



HR500S ACCESS READER WITH SIEDLE COVER FOR OUTDOOR USE

Online/offline reader with contactless MIFARE reader; mounting in Siedle casing; standard: Siedle 611, silver; RS485 interface (2-wire) for connection to a control unit (optional); power supply by external power supply; delivery does not include Siedle frame

► YOUR BENEFITS

- Contactless reader technology
- Online operation with HAC5000/32
- Optical status indication provided by 3 LEDs
- Acoustic status indication by signal generator
- Permanent door release
- Power supply of reader and door strike by external power supply
- Reading range up to 5 cm
- For outdoor use

▼ ACCESS READER WITH COVER

MH8733 HR500S, MIFARE Classic

For further colour options, see "Hotel Accessories".

▼ ACCESSORIES AND OPTIONS

MH8772 Rack mount power supply unit 30 W

MH8773 Rack mount power supply unit 60 W

Hotel Hardware

Access Reader with DND/MUR Status Indication for Door Controller



HRC500S ACCESS READER WITH SIEDLE COVER FOR OUTDOOR USE

Online/offline reader with contactless MIFARE reader; mounting in Siedle casing; standard: Siedle 611, silver; RS485 interface (2-wire) for connection to a door controller; power supply via door controller by external power supply; delivery does not include Siedle frame

Operation only in combination with an HDC15.

► YOUR BENEFITS

- Contactless reader technology
- Online operation with HAC5000/32
- Optical status indication provided by 3 LEDs
- Acoustic status indication by signal generator
- Permanent door release
- Power supply of reader, door controller and door strike by external power supply
- Reading range up to 5 cm
- For outdoor use

▼ ACCESS READER WITH COVER

MH8227 HRC500S, MIFARE Classic

Operation only in combination with an HDC15.
For further colour options, see "Hotel Accessories".

▼ ACCESSORIES AND OPTIONS

MH4385 HDC15 Door Controller
MH8772 Rack mount power supply unit 30 W
MH8773 Rack mount power supply unit 60 W

Hotel Hardware Elevator Reader



HR500A ELEVATOR READER

Online/offline reader with contactless MIFARE reader; mounting in elevator tableau; RS485 interface (2-wire) for connection to a control unit (optional); power supply by external power supply

► YOUR BENEFITS

- Contactless reader technology
- Online operation with HAC5000/32
- Optical status indication provided by 3 LEDs
- Acoustic status indication by signal generator
- Permanent door release
- Power supply of reader and door strike by external power supply
- Reading range up to 5 cm

▼ ELEVATOR READER

MH8734 HR500A Elevator Reader

▼ ACCESSORIES AND OPTIONS

MH8772 Rack mount power supply unit 30 W
MH8773 Rack mount power supply unit 60 W

Hotel Hardware

Elevator Reader for Door Controller



HRC500A ELEVATOR READER

Online/offline reader with contactless MIFARE reader; mounting in elevator tableau; RS485 interface (2-wire) for connection to a door controller; power supply via door controller by external power supply

Operation only in combination with an HDC15.

► YOUR BENEFITS

- Contactless reader technology
- Online operation with HAC5000/32
- Optical status indication provided by 3 LEDs
- Acoustic status indication by signal generator
- Permanent door release
- Power supply of reader, door controller and door strike by external power supply
- Reading range up to 5 cm

▼ ELEVATOR READER

MH8211 HRC500A Elevator Reader

Operation only in combination with an HDC15.

▼ ACCESSORIES AND OPTIONS

MH4385 HDC15 Door Controller
MH8772 Rack mount power supply unit 30 W
MH8773 Rack mount power supply unit 60 W

PegaSys

Full-Frame Doors and Tubular Frame Doors



PEGASYS INDOOR AND OUTDOOR

PegaSys Terminals B and S for indoor use.
For first order, a PegaSys programming cardset has to be ordered. Products on page 61..

PegaSys Terminals B for outdoor use

- IP 55, in combination with an inside battery compartment MN1004

PegaSys Terminals S for outdoor use

- IP 55, in combination with an inside battery compartment MN1005

For first order, a PegaSys programming cardset has to be ordered. For the reading system
Products on page 61.

► YOUR BENEFITS

- Stainless steel door handle
- With PZ-perforation or blind
- Mounting plate matching to door fittings (inside)
- With adapter for square spindle and lever handle and all further necessary accessories for professional mounting of the indoor fitting
- Including lithium batteries
- With inner lever handle set containing rosettes and short or long plates
- Suitable for wood, steel or metal doors (PegaSys B)
- Without cylinder and mortise lock
- Certified for fire protection approval P-120003473
- Suitable for small frames in wood, steel or aluminium (PegaSys S)

▼ PEGASYS

- | | |
|--------|--|
| MN1099 | Door terminal PegaSys B MIFARE Classic |
| MN1100 | Door terminal PegaSys S MIFARE Classic |

▼ ACCESSORIES AND OPTIONS

- | | |
|--------|---|
| MN1004 | Battery compartment self-engaging for door terminal PegaSys B |
| MN1005 | Battery compartment screwed; for door terminal PegaSys S |

Supported data formats: 2.0, 2.1 and 3.1

Note: PegaSys is not suitable for hotel room doors.

PegaSys

Electronic Lock Cylinder



ELECTRONIC DOUBLE-KNOB LOCK CYLINDER / PEGASYS TYPE 1 (SINGLE-SIDED BOOKING)

The cylinder consists of a profile cylinder and two knob modules, a mere mechanical and an electronic knob module. The turning knob is firmly connected to the locking nose on the mechanical side. On the electronic side, the turning knob can rotate freely. Only after successful authorization, the coupling unit will be activated and the cylinder can be un-/locked. The special cylinder body is equivalent to DIN 18254, therefore it can be plugged in into already existing mortise locks. The communication electronics and the batteries are both located in the mechanical knob module. By exchanging the profile cylinder the double-knob lock cylinder can be adapted to all particular door thicknesses.

IP 55: Fire protection approval / IP 65: Outdoor solution



ELECTRONIC HALF CYLINDER BODY / PEGASYS TYPE 2

The cylinder consists of a mechanical knob module and a profile half cylinder body. Only after successful authorization, the electronic coupling unit will be activated and the cylinder can be un-/locked. The communication electronics and the batteries are located in the knob module.

IP 55: Fire protection approval

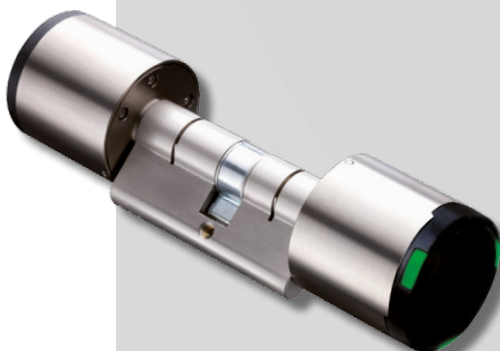

ELECTRONIC DOUBLE-KNOB LOCK CYLINDER / PEGASYS TYPE 3 (DOUBLE-SIDED BOOKING)

The cylinder (appropriate for double-sided booking) consists of a profile cylinder body and two electronic knob modules, which can each rotate freely. Only after successful authorization (from outside as well as from inside), the electronic coupling unit will be activated and the cylinder can be un-/locked. The special profile cylinder body is equivalent to the DIN 18254, therefore it can be plugged in into already existing mortise locks. The communication electronics and the batteries are each located in the electronic knob module. By exchanging the profile cylinder the double-knob lock cylinder can be adapted to all particular door thicknesses.

IP 55: Fire protection approval

PegaSys

Electronic Lock Cylinder

ELECTRONIC KNOB CYLINDER

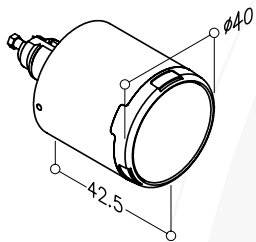

For first order, a PegaSys programming cardset has to be ordered. For the reading system MIFARE DESFire an OEM 2-licence is necessary once for the start.
Products on page 57.

▼ FOR INDOOR USE

MN1006 Electronic knob cylinder for indoor use, MIFARE Classic / DESFire 2.0

▼ FOR OUTDOOR USE

MN1008 Electronic knob cylinder for outdoor use, MIFARE Classic / DESFire 2.0

MECHANICAL KNOB

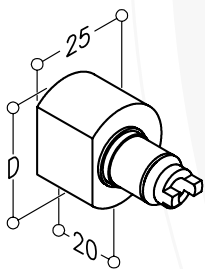

▼ MECHANICAL KNOB

MN1010 Mechanical knob for internal door side, 29.5 mm (standard)

MN1011 Mechanical knob for internal door side, 34 mm

CYLINDER BODY (EURO PROFILE)

Other cylinder bodies on request.

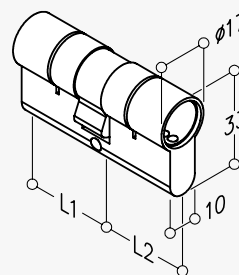

▼ CYLINDER BODY

MN1012 Cylinder body 30/30 mm (standard)

HALF CYLINDER BODY

Other half cylinder bodies on request.

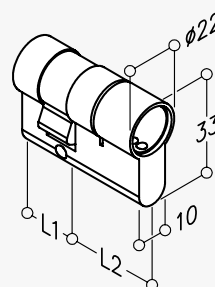

▼ HALF CYLINDER

MN1067 Half cylinder body 30/10 mm (standard)

Note: PegaSys is not suitable for hotel room doors.

PegaSys Electronic Locker Lock



ELECTRONIC LOCKER LOCK

For first order, a PegaSys programming cardset has to be ordered. For the reading system MIFARE DESFire an OEM 2-licence is necessary once for the start.

These products can be found on the following page.

► YOUR BENEFITS

- IP20 for indoor area
- Suitable for wood, steel and aluminium doors with a thickness of up to 20 mm

▼ ELECTRONIC LOCKER LOCK

MN1076

PegaSys Locker Lock MIFARE Classic

Note: PegaSys is not suitable for hotel room doors.

PegaSys Programming Cards



PROGRAMMING CARDSET PEGASYS

Programming cardset of PegaSys locking system; with FC card, security card, dismounting card, and battery changing card

▼ PROGRAMMING CARDSET

MN1080 PegaSys programming cardset
MIFARE Classic

Note: PegaSys is not suitable for hotel room doors.



Accessories

Hardware

Door Controller



HDC15 DOOR CONTROLLER

Control module for standalone operation or with HAC5000/32; for all HRC readers; RS485 interface (2-wire) for connection to HAC5000/32; DIN rail mounting; 5 relay outputs; 5 optocoupler inputs

► YOUR BENEFITS

- Power supply of reader, door controller and door strike by external power supply
- Flexible access rights via access group
- Person-related single-door release
- Blocked days, public holidays regulation
- Black list for blocked cards
- Door release time can be freely selected
- Automatic time-controlled release/closing
- Storage of the last 1.500 bookings
- Electric circuit release with energy-saving terminal or access booking / master-off
- Distinction of guest and employee cards with HRC910 BJE
- Welcome light with access booking

▼ DOOR CONTROLLER

MH4385 HDC15 Door Controller for milock MTZ® Hotel

▼ ACCESSORIES AND OPTIONS

MH8772 Rack mount power supply unit 30 W
MH8773 Rack mount power supply unit 60 W

Hardware

Door Controller



HDC16 DOOR CONTROLLER

Control module for standalone operation or with HAC5000/32; optimized for room automation; can be operated without reader; address setting directly at the device; RS485 interface (2-wire) for connection to HAC5000/32; DIN rail mounting; 5 relay outputs; 5 optocoupler inputs

► YOUR BENEFITS

- Power supply by external power supply
- Address setting directly at the HDC
- Operation possible without reader

▼ DOOR CONTROLLER

MH5303 HDC16 Door Controller for milock Hotel with addressing

▼ ACCESSORIES AND OPTIONS

MH8772 Rack mount power supply unit 30 W

Accessories

Light Control

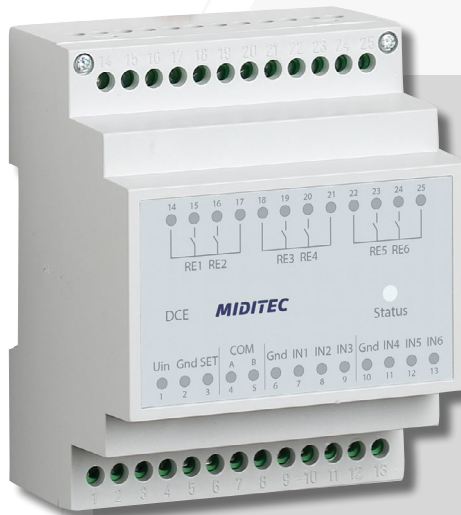

HDCL LIGHT EXTENSION

Extension for HDC15; RS485 interface (2-wire) for connection to HDC15; DIN rail mounting; 6 relay outputs; 6 optocoupler inputs; for factory-set light scenarios

► YOUR BENEFITS

- Power supply of reader, door controller and door strike by external power supply
- Optical status indication provided by colour LED
- Relay outputs for up to 6 light circuits
- Inputs for up to 6 light switches
- Welcome light and light scenarios via door controller
- Energy circuit release via door controller
- Up to 2 HDCL per door controller

▼ LIGHT EXTENSION

MH4726

HDCL Light Extension

Accessories

Climate Control

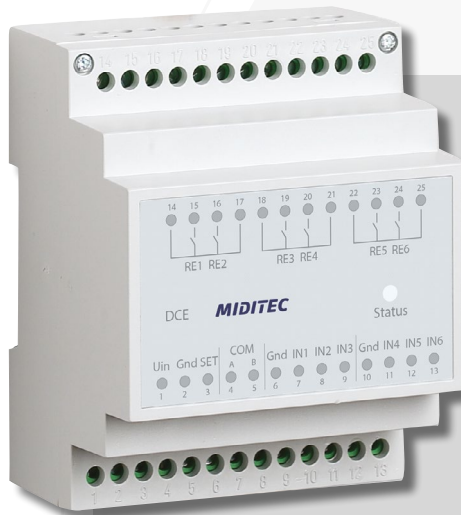

HDCC CLIMATE EXTENSION

Extension for HDC15; RS485 interface (2-wire) for connection to an HDC15; DIN rail mounting; 1x relay output for cooling; 1x relay output for heating; 3x relay outputs for fan stages; 2x relay inputs for error messages of the external air ventilation system

Operation only in combination with an HDC15 and the climate modules HC630 or HC3530.

► YOUR BENEFITS

- Power supply of climate module and door controller by external power supply
- Optical status indication provided by multicolor LEDs
- 1 relay output for cooling
- 1 relay output for heating
- 3 relay outputs for different fan stages
- 2 relay inputs for error messages of external air ventilation system

▼ CLIMATE EXTENSION

MH9132 HDCC Climate Extension

Operation only in combination with an HDC15 and the climate modules HC630 or HC3530.

Accessories

Key Coder



*Fig. similar

LH950 DESKTOP KEY CODER

Programming of person and system cards; login reader / declaration reader for use of unique numbers; USB interface for connection to a PC

▼ KEY CODER

MH8964 Hotel Solution LH950 key coder

▼ DELIVERY INCLUDES

1 USB cable

Accessories

ID Cards | Key Rings



1K CARD

ID card; white; credit card format; programmed; high data transfer rate; multi-application capable; ISO/IEC 14443A

MH4690

Card 1K, blank

MH4691

Card 1K, printing single- or both-sided, 4-colour print



MIFARE CLASSIC 1 K PLEXIGLASS KEY RING

Plexiglass key ring with a distinguished design; programmed; high data transfer rate; application of energy-saving terminals on request

MH4675

Plexiglass key ring MIFARE Classic 1 K



MIFARE CLASSIC 1 K KEY RING

Key ring black-grey, programmed; high data transfer rate; multi-application-capable; ISO/IEC 14443A

MH4681

Key ring MIFARE Classic 1 K

Note: For our key rings a minimum order quantity of 12 pieces is required.



MIFARE CLASSIC 1 K KEY RING "EVOLUTION"

Key ring in different colours, programmed; ABS plastic with polished stainless steel frame

MH4698

Key ring "Evolution" MIFARE Classic 1 K

Please specify your favorite colour on the order.

Accessories

Power Supply Units



RACK MOUNT POWER SUPPLY UNIT 30 W

Power supply for up to 2 readers with door strike or for up to 2 readers with door controller and door strike (door strike up to 250 mA and free wheeling diode); insulation class II ; protection against short circuit, overload and excess voltage; DIN-rail mounting; LED „Power on“ indicator.



RACK MOUNT POWER SUPPLY UNIT 60 W

Power supply for up to 4 readers with door strike or for up to 4 readers with door controller and door strike (door strike up to 250 mA and free wheeling diode); insulation class II ; protection against short circuit, overload and excess voltage; DIN-rail mounting; LED „Power on“ indicator.

▼ POWER SUPPLY UNITS

MH8772	Rack mount power supply unit 30 W
MH8773	Rack mount power supply unit 60 W

Accessories

Door Terminals | PegaSys

PEGASYS

MN1089	Lithium battery micro (AAA) narrow 1,5 V for a door terminal PegaSys S	MN1093	PegaSys battery compartment key wide for door terminal PegaSys B
MN1090	Lithium battery mignon (AA) wide 1,5 V for a door terminal PegaSys B	MN1094	PegaSys battery compartment key narrow for door terminal PegaSys S Battery compartment key also useable for locker lock
MN1091	Lithium battery mignon (AA) 3,6 V for a locker lock	MN1095	Battery changing tools (5 units) for electronic lock cylinder
MN1092	Lithium CR2 battery for electronic lock cylinder	MN1096	PegaSys battery compartment wide for door terminal PegaSys B without batteries
		MN1097	PegaSys battery compartment narrow for door terminal PegaSys S without batteries

Accessories

Profile Half Cylinder Body



PROFILE HALF CYLINDER BODY

Mechanical profile half cylinder body for mechanical emergency opening from milock FOCUS or PegaSys door terminals with security card, simultaneous looking to 6 spring mounted pin tumblers in EU profile.

► YOUR BENEFITS

- EU profile
- 6 spring mounted pin tumblers
- Trademarked multi-profile system
- Locking cam 8-times adjustable
- With security card
- Simultaneous locking

▼ PROFILE HALF CYLINDER BODY

MH4806 Profile half cylinder body 30-10 with security card

MH4807 Profile half cylinder body 35-10 with security card

Please specify the number of keys throughout ordering.

Accessories

Technology Meets Design

As leading technology provider MIDITEC cooperates only with the best also in regards to design. For many years already, names such as Busch-Jaeger, Jung, Berker, Gira, and Siedle stand for first-class products of the building and communication technology. Like MIDITEC these companies produce their products in Germany.

The results of this cooperation speak for itself: technologically high-quality comprehensive solutions with aesthetically demanding flush-mounted components in a wide selection and in highest manufacturing quality.

Furthermore, for all projects we work very closely with hoteliers, architects, and designers which has led to one or another completely new, individual product.



Busch-Jaeger design example



Jung design example



Berker design example



Siedle design example

Accessories

Design Examples Hotel BJE

BUSCH-JAEGER DESIGNS FOR 400 AND 420 READER



MH8121 pure stainless steel



MH8124 pure stainless steel



MH8120 future linear silver



MH8123 future linear silver



MH8122 future linear
black-matt



MH8125 future linear
black-matt

Accessories

Design Examples: Hotel BJE

BUSCH-JAEGER DESIGNS FOR ACCESSORIES



MH8126 pure stainless steel



MH8127 pure stainless steel

BUSCH-JAEGER DESIGNS FOR ACCESSORIES IN DOUBLE FRAME



MH8128 pure stainless steel



MH8129 future linear
black matt

Further modules, colours and series on request. Extra charges and longer delivery times will apply.
The colours represented in this product catalogue may deviate from the original colours.

Accessories

Siedle Reader Colour Options

SIEDLE COVER COLOUR OPTIONS HRC500S

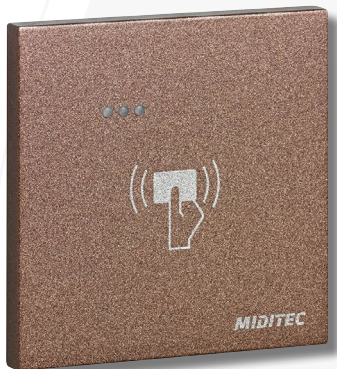

MH8130

amber glimmer

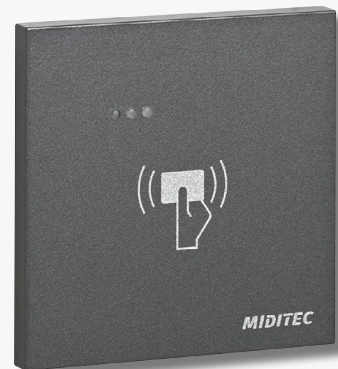

MH8131

dark-grey glimmer



MH8132

white



MH8133

black high-gloss

Hospitality

Configuration Example Room Automation

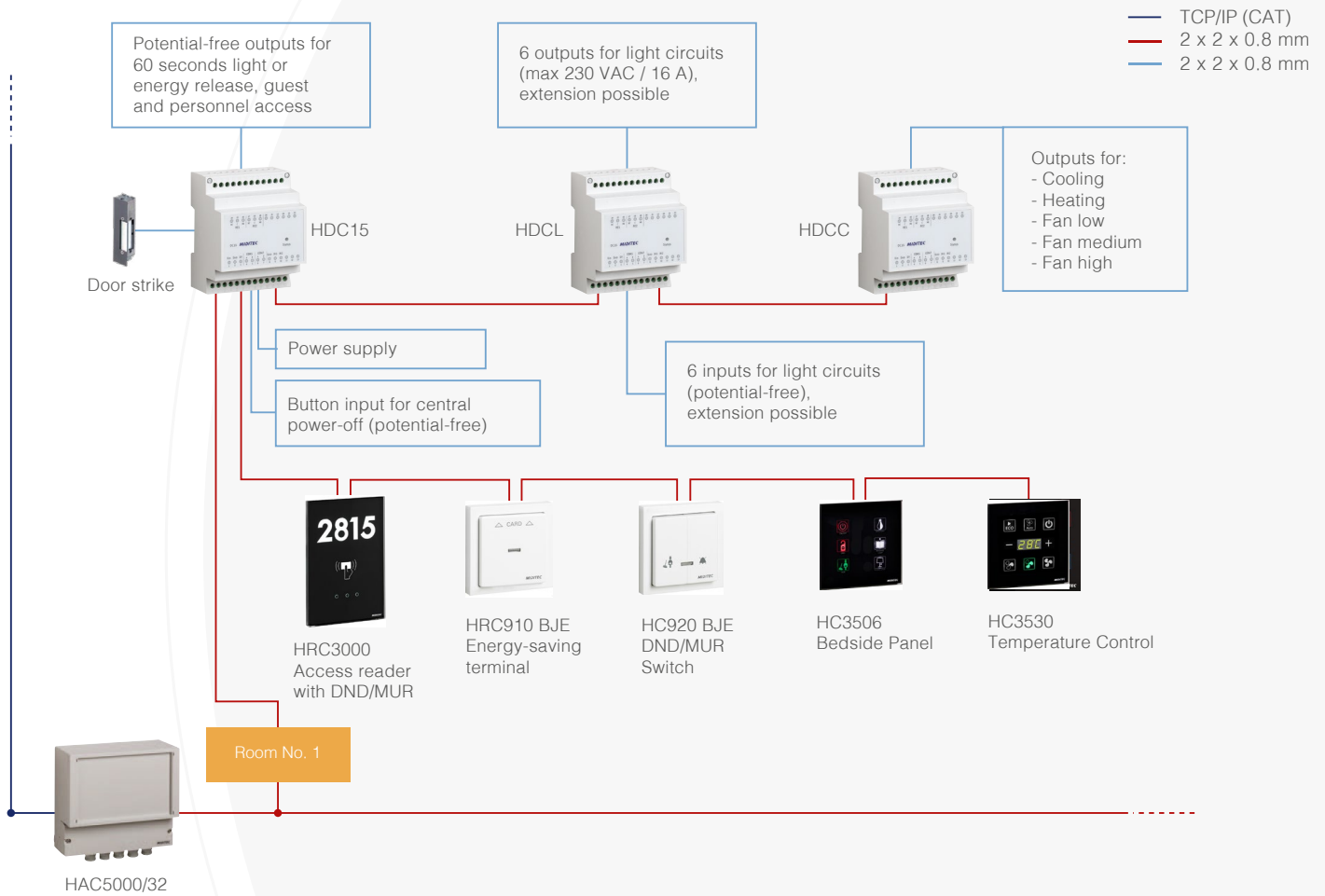

Hospitality

Configuration Examples milock Hotel

H420 BJE, H940 BJE, AND HDC920 BJE

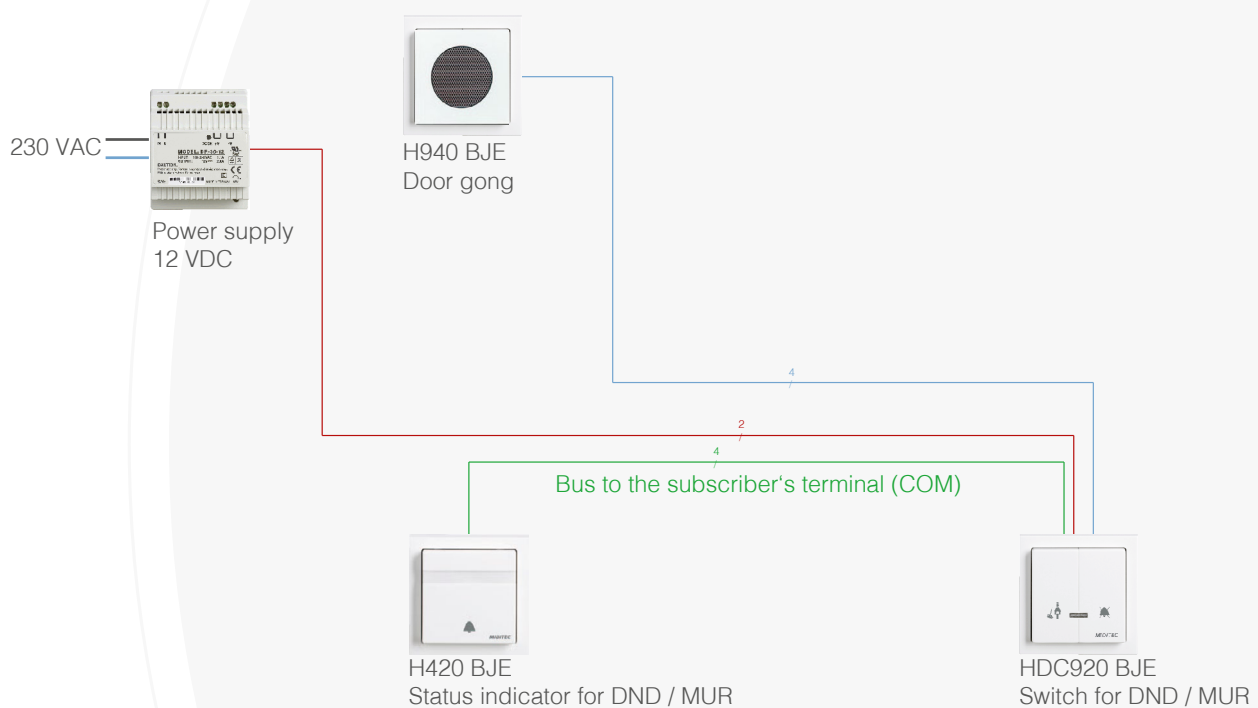

► ALTERNATIVES

- With hotel reader HRC420 BJE instead of signalling unit H420 BJE
 - for DND / MUR indication
 - with bell function
 - with door strike and access function
- With HDC920 BJE DND instead of HDC920 BJE
 - for DND-ON / DND-OFF instead of DND / MUR

Optional:

milock wireless lock
in the existing building



Hospitality

Configuration Examples milock Hotel

HRC400 BJE AND HDC15

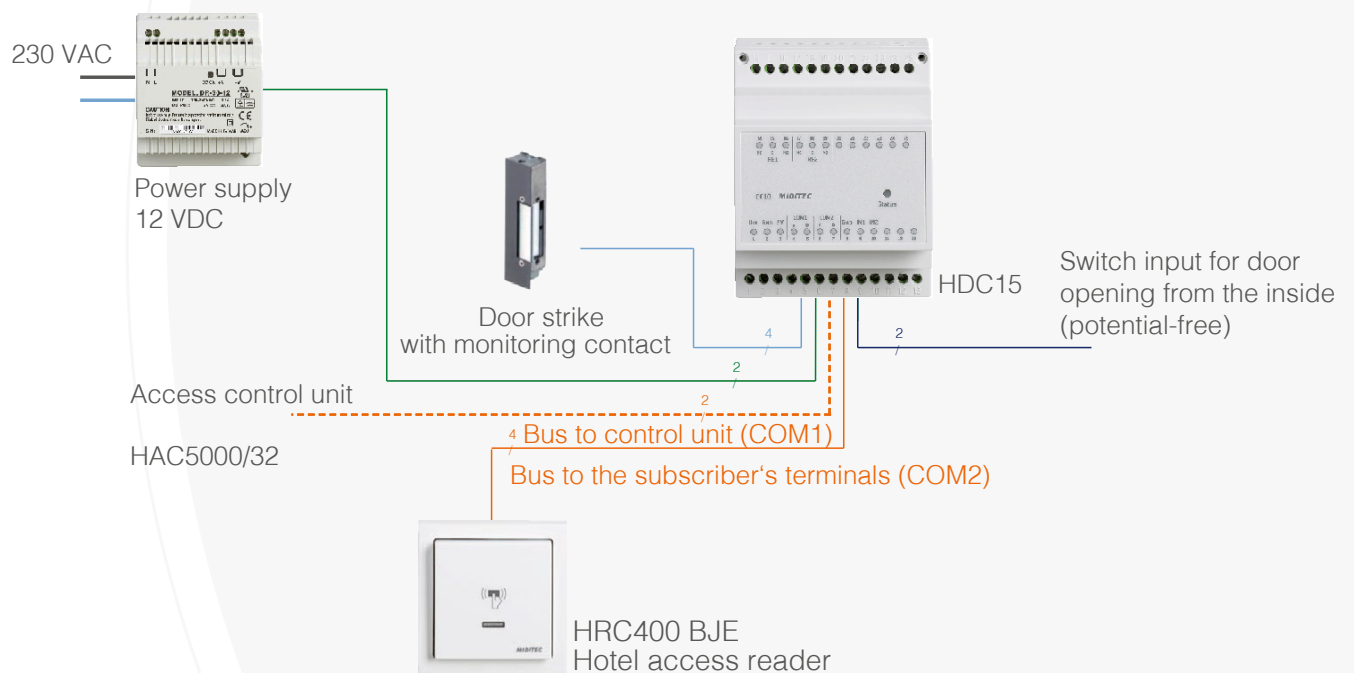

Hospitality Configuration Examples

ACCESS MANAGEMENT WITH DOOR CONTROLLER OR MILOCK FOCUS

- RS422 (cable J-Y(ST)Y 2 x 2 x 0.8 mm)
- 230 VAC

ACCESS MANAGEMENT DOOR CONTROLLER

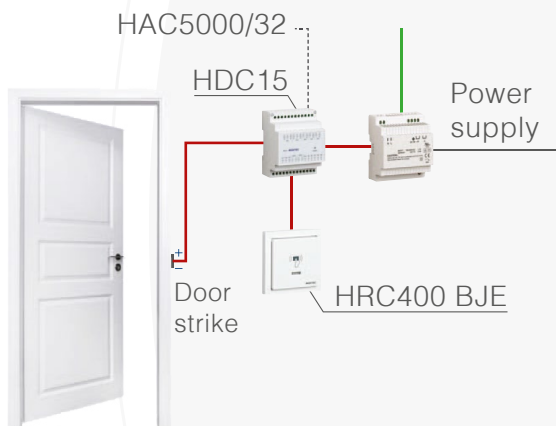

ACCESS MANAGEMENT WITH MILOCK FOCUS



Hospitality

Configuration Examples milock Hotel

HRC420, HRC910 BJE, HC920 BJE, H940 BJE, 2X HDCL

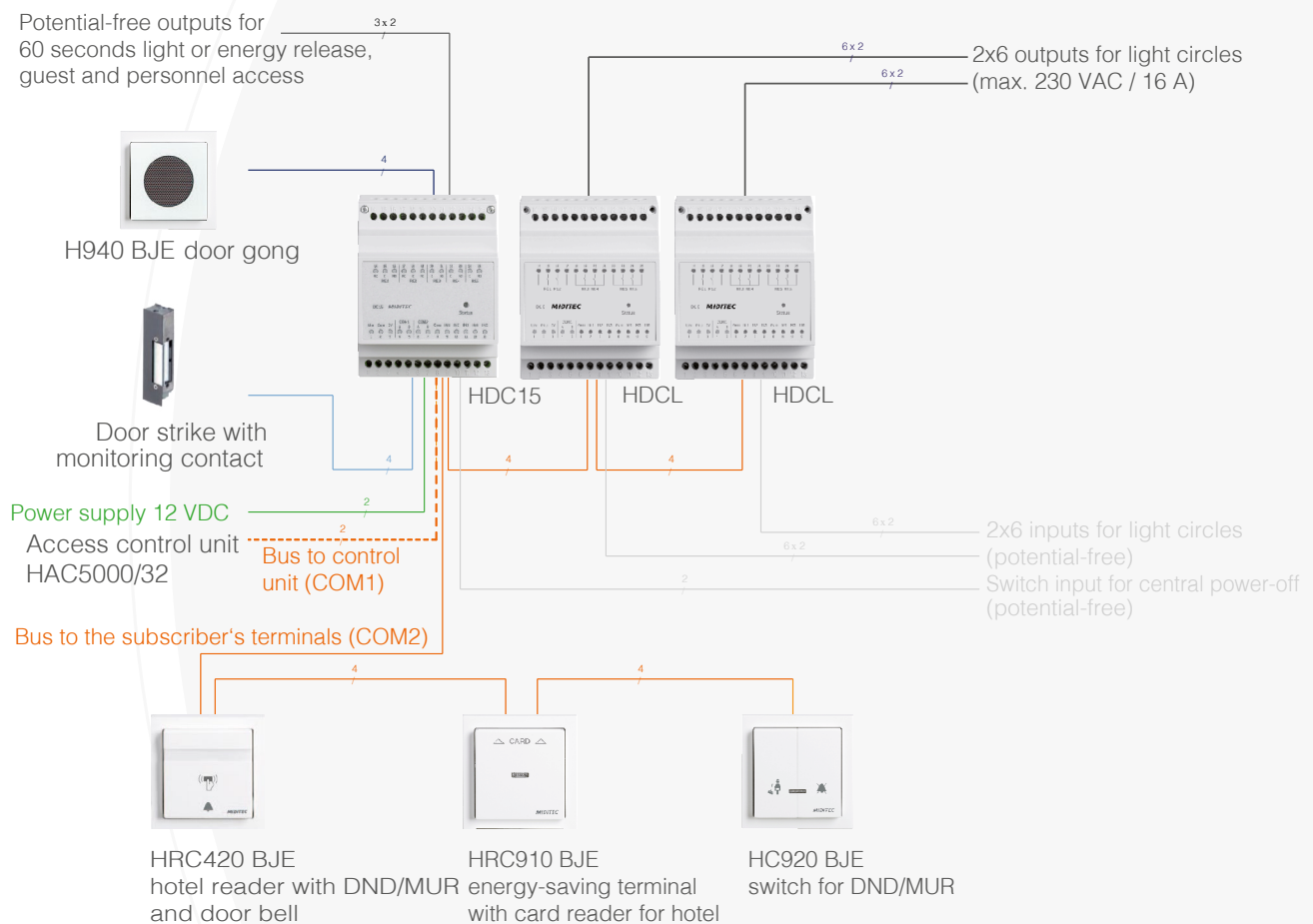

► ALTERNATIVES

- Without HDCC and without HC930 BJE for climate control
- With HDCL or also without HDCL for light control
- With energy-saving terminal H910 BJE instead of HRC910 BJE (without outputs for guest and personnel access)
- With HC920 BJE_DND instead of HC920 BJE (for DND-ON / DND-OFF instead of DND / MUR)

Hospitality

Time Management



Our hotel solutions also refer to the hotel staff. With MIDITEC Time you manage your staff efficiently and safely.

As the saying goes "Time is money". This applies especially to working time. Whether it is the start of the working day, a break, or the finishing time: with a terminal in the entrance area, every coming and going can be recorded. The information collected can be used in various ways. There are numerous software interfaces enabling automatic takeover of the data and further processing by most of the current payment and salary systems. If technological infrastructures of access management already exist, they can be used for time management and further applications with only a low degree of effort.

MTZ® TIME

The software module behind the business solution is MTZ® Time. This module allows to adapt working time modules to the individual requirements of the company. Shift work and overtime are taken into account as well as flexible working times, authorised absences and allocated working times. By means of additional modules, also external departments, field service employees and home offices can be integrated into the workflow.



MIDITEC		ZEIT	BDE	FAVORITEN	
Personentableau		Max Mustermann			
Fr, 16.10.2015 13:45					
1. Nachname_746, Vornam...	92. Nachname_821, Vornam...	13. Nachname_821, Vornam...	20. Nachname_821, Vornam...	27. Nachname_821, Vornam...	
Abwesend	Abwesend	Abwesend	Abwesend	Abwesend	
52. Nachname_753, Vornam...	6. Nachname_821, Vornam...	12. Nachname_826, Vornam...	19. Nachname_821, Vornam...	26. Nachname_821, Vornam...	
Anwesend 08:00	Abwesend	Berufsschule bis Fr, 16.10.2015	Abwesend	Abwesend	
36. Nachname_813, Vornam...	9. Nachname_821, Vornam...	15. Nachname_821, Vornam...	40. Nachname_842, Vornam...	83. Nachname_724, Vornam...	
Abwesend	Abwesend	Abwesend	Abwesend	Abwesend	
34. Nachname_821, Vornam...	29. Nachname_745, Vornam...	17. Nachname_821, Vornam...	74. Nachname_826, Vornam...	43. Nachname_823, Vornam...	
Abwesend	Krank bis Fr, 16.10.2015	Abwesend	Berufsschule bis Fr, 16.10.2015	Abwesend	
24. Nachname_479, Vornam...	68. Nachname_706, Vornam...	28. Nachname_821, Vornam...	39. Nachname_840, Vornam...	78. Nachname_816, Vornam...	
Abwesend	Abwesend	Abwesend	Abwesend	Abwesend	
20. Nachname_821, Vornam...	38. Nachname_766, Vornam...	87. Nachname_755, Vornam...	9. Nachname_821, Vornam...	23. Nachname_821, Vornam...	
Abwesend	Abwesend	Berufsschule bis Fr, 16.10.2015	Abwesend	Abwesend	
84. Nachname_829, Vornam...	39. Nachname_840, Vornam...	79. Nachname_808, Vornam...	54. Nachname_821, Vornam...	31. Nachname_821, Vornam...	
Abwesend	Abwesend	Abwesend	Abwesend	Abwesend	
22. Nachname_861, Vornam...	7. Nachname_821, Vornam...	2. Nachname_745, Vornam...	40. Nachname_821, Vornam...	90. Nachname_814, Vornam...	
Abwesend	Abwesend	Urlaub ganzer Tag bis Fr, 16.10.2015	Abwesend	Abwesend	
4. Nachname_753, Vornam...	41. Nachname_746, Vornam...	1. Nachname_821, Vornam...	18. Nachname_753, Vornam...	6. Nachname_821, Vornam...	
Abwesend	Abwesend	Abwesend	Anwesend 12:46	Abwesend	
89. Nachname_765, Vornam...	77. Nachname_753, Vornam...	27. Nachname_821, Vornam...	25. Nachname_821, Vornam...	22. Nachname_861, Vornam...	
Abwesend bis Do, 31.12.2015	Abwesend	Abwesend	Abwesend	Abwesend	
15. Nachname_821, Vornam...	57. Nachname_744, Vornam...	70. Nachname_922, Vornam...	77. Nachname_753, Vornam...	7. Nachname_821, Vornam...	
Abwesend	Abwesend	Abwesend	Anwesend	Abwesend	
61. Nachname_751, Vornam...	32. Nachname_125, Vornam...	52. Nachname_753, Vornam...	62. Nachname_924, Vornam...	4. Nachname_753, Vornam...	
Abwesend	Abwesend	Anwesend 08:00	Fortbildung bis Fr, 16.10.2015	Anwesend	

MTZ® Personnel panel



Service

Trainings

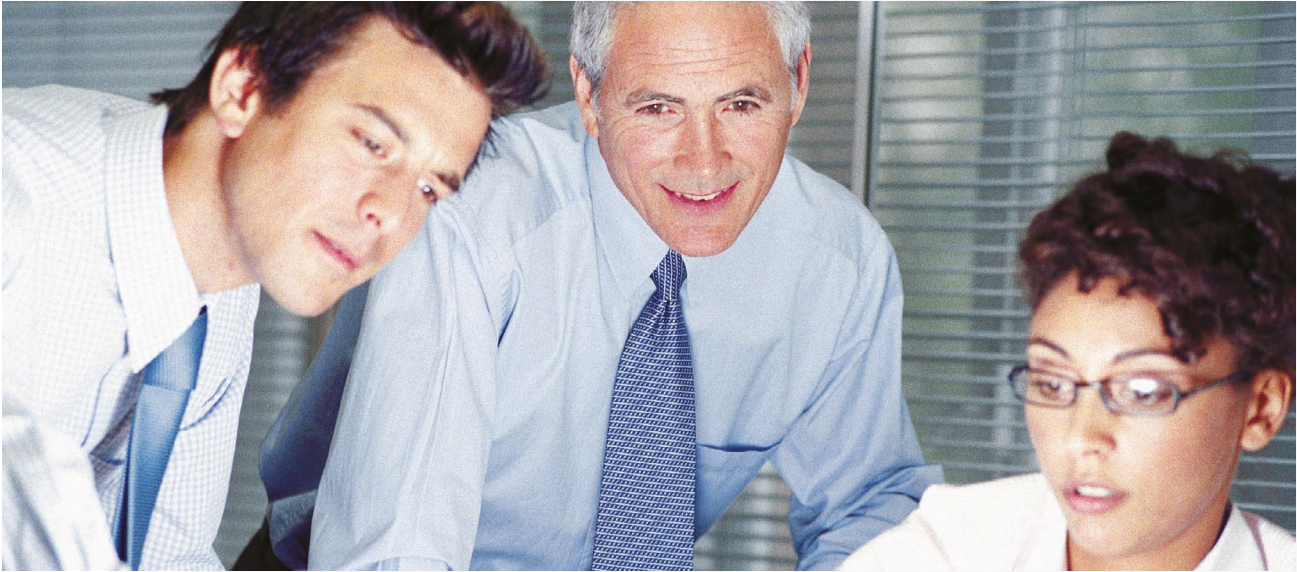

▼ TRAINING

MD5900	Training per day
MD5901	Training per hour

On-site training; training dates to be defined individually.

▼ GROUP TRAINING

MD5910	Per trainee and day
--------	---------------------

Training at fixed dates and location.
Refreshments and lunch included.
Minimum number of trainees: 3

▼ HOTLINE / SUPPORT

MD5920	Hotline / Support for every started 15 minutes
MD5921	Hotline / Support without software service license contract for every started 15 minutes

▼ BRIEFING AND COMMISSIONING

MD5930	External SAP System Integrator, SAP side
MD5931	MIDITEC SAP System Integrator, MTZ Business Solution side
MD5932	MIDITEC Development Engineer and Project Manager (per day)
MD5935	Installation of software and system parameterisation
MD5940	Graphic services and design, per hour
MD5941	Project planning door list per day
MD5942	Project planning door list per hour
MD5952	Checking the use of existing identification cards for a MIDITEC system



References

References

National References

InterContinental, Berlin



Boutique-Hotel Ketschauer Hof, Deidesheim



References

International References

The Yas Viceroy Hotel, Abu Dhabi



Jumeirah at Etihad Towers Hotel, Abu Dhabi



La Cigale Hotel Doha, Qatar

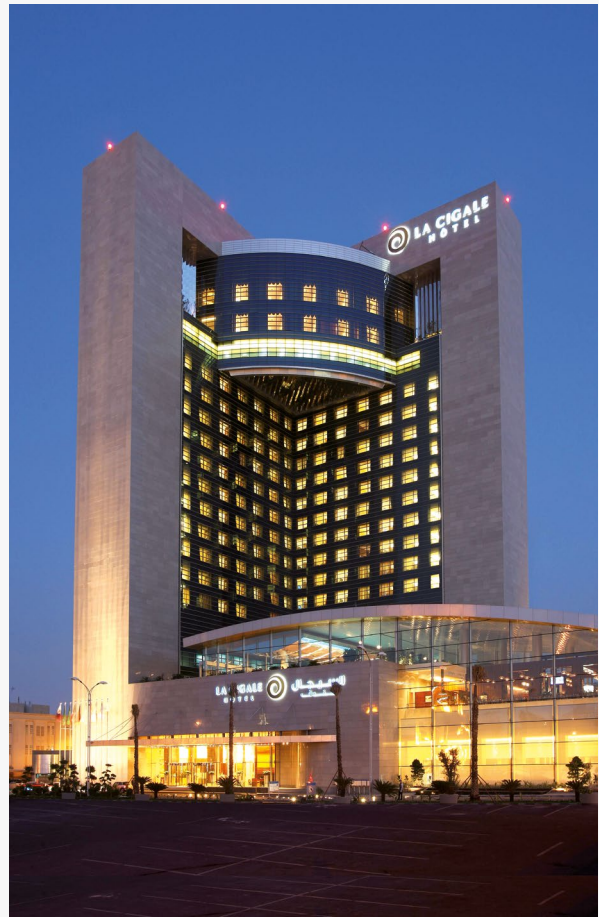

Published by: MIDITEC
Datensysteme GmbH
Subjects to errors and
alterations

MIDITEC
Datensysteme GmbH
Anne-Conway-Straße 5
28359 Bremen

Tel.: +49(0)421 17581-0
Fax: +49(0)421 17581-30
info@miditec.de
www.miditec.de



MIDITEC
SECURITY SYSTEMS